

INSTALLATION INSTRUCTIONS FOR PT1415A REFRIGERATOR DRAIN KIT

Use the PT1415A drain kit for refrigerators experiencing these issues.

- Leaking water under crisper drawers.
- Fan noise when refrigerator door is closed.

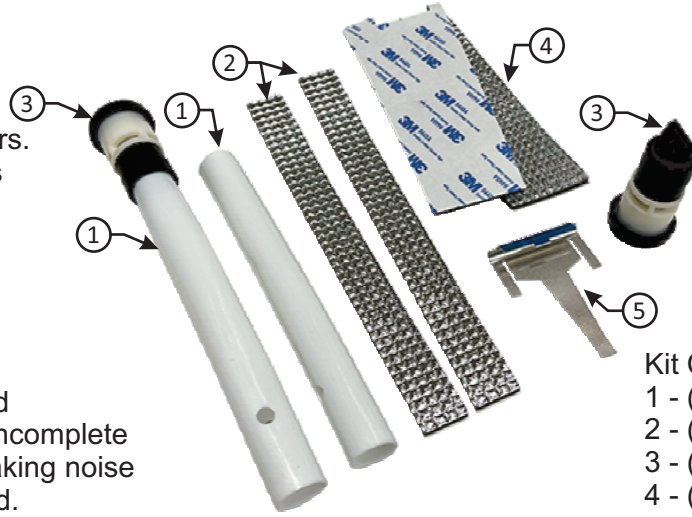

WARNING
Disconnect power before servicing equipment.

When to change your drain kit:

- Build-up of ice above the fresh food evaporator due to air intrusion or incomplete defrost. Ice can inhibit the fan, making noise that stops when the door is opened.
- The drain tube becomes clogged due to debris in the valve "duck bill". The defrost water then backs up into the drain pan under the evaporator, where it will freeze. Every time the evaporator defrosts, water will then run over the drain pan, collecting under or in the crisper drawers.

Kit Contents

- 1 - (2) Drain Tubes
- 2 - (2) Foam Strips
- 3 - (2) Caps
- 4 - (2) Foam Seals
- 5 - (1) Defrost Heater Clip

Figure 1 Sensor Facing Rear (incorrect)



Figure 2 Sensor Facing Left (correct)



Directions

1. Disconnect power from refrigerator.
2. Remove (2) external drain tubes with duckbills.
3. Remove the evaporator cover.
4. Use steamer to melt any ice from top of evaporator. We recommend DFSTEAMERHD.
5. Check defrost heater and sensor. Make sure they are functioning correctly. Use an ohm meter for verification. Replace defective parts. If sensor has been covered in ice, use steamer to defrost sensor, drain pan and drain tube. Pour hot water down drain to ensure the ice is dissolved. Replace sensor if it was covered in ice. (Fig. 1 & 2)
7. Carefully lift evaporator and drain plate and bend up.
8. Attach (2) foam strips to the back of the plate if plate doesn't have them (Fig. 3 & 4), and add seal to bottom of drain plate.
9. Reset evaporator and drain plate to original position, making sure they are secure.
10. Bend bottom row of cooling ribs on evaporator. (Fig. 5)
11. Replace old heater drain clip with new one. Wrap clip securely around the heater so the tail doesn't touch the plastic liner. (Fig. 6)
12. Install new drain tubes/Duck Bill (Fig. 7 & 8)
13. Re-Attach compressor cover. Check the installation of the new drain tubes after clearing the drain. Once tubes are installed, if duck bill becomes clogged, drain water won't travel back up the drain pipe and freeze again. This will prevent freezing in the freezer section drain.
14. Reconnect power.

Figure 3 Back of plate without foam strips



Figure 4 Back of plate with foam strips



Figure 5



Figure 6

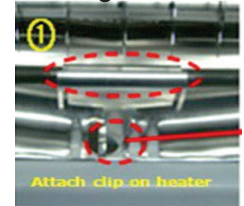

Figure 7 New Drain Tube/Duck Bill

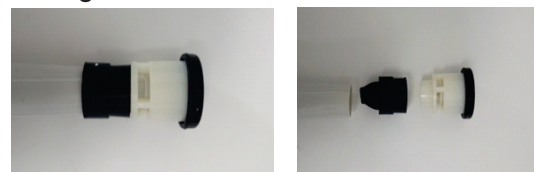

Figure 8 New Drain Tube Installation

