

SECTION A-A

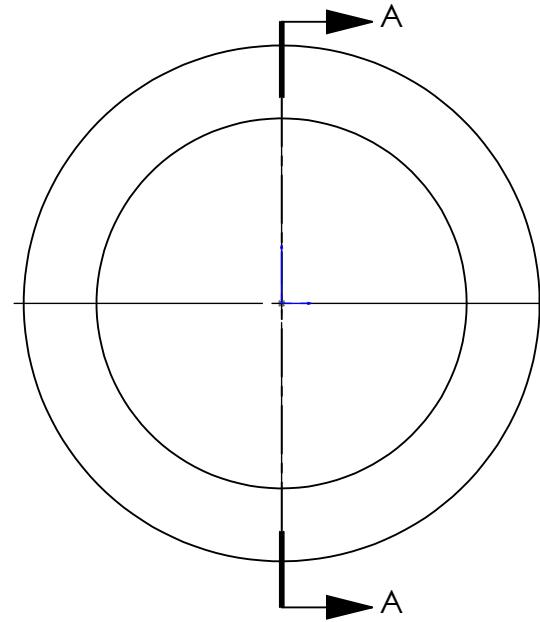

| REV. | DATE | CHANGE | UNLESS OTHERWISE SPECIFIED: | NAME | DATE | REMKE REMKE INDUSTRIES 310 CHADDICK DR, WHEELING, IL. 60090 | |
|------|----------|----------|--|---|-------|---|--|
| A | 12/31/13 | RELEASED | DIMENSIONS ARE IN INCHES TOLERANCES: FRACTIONAL $\pm 1/64$ ANGULAR: MACH $\pm 1^\circ$ BEND $\pm 1^\circ$ ONE PLACE DECIMAL $\pm .015$ TWO PLACE DECIMAL $\pm .010$ THREE PLACE DECIMAL $\pm .005$ | DRAWN JCN | 12/13 | TITLE: BUSHING | |
| | | | INTERPRET GEOMETRIC TOLERANCING PER: | ENG APPR. | | SIZE DWG. NO. REV A SRB-1202 A | |
| | | | MATERIAL NEOPRENE | MFG APPR. | | SCALE: 1:2 SHEET 1 OF 1 | |
| | | | FINISH NATURAL | Q.A. | | | |
| | | | DO NOT SCALE DRAWING | PROPRIETARY AND CONFIDENTIAL THE INFORMATION CONTAINED IN THIS DRAWING IS THE SOLE PROPERTY OF REMKE INDUSTRIES. ANY REPRODUCTION IN PART OR AS A WHOLE WITHOUT THE WRITTEN PERMISSION OF REMKE INDUSTRIES IS PROHIBITED. | | | |

5

↑

4

3

2

1