

# LVP+ CARPET AND VELOUR SUBSTRATES

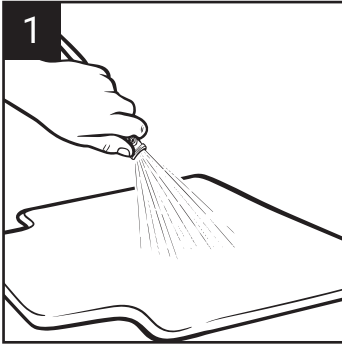

Watch Video

## Application Instructions



1 Clean with an upholstery cleaner/shampoo.

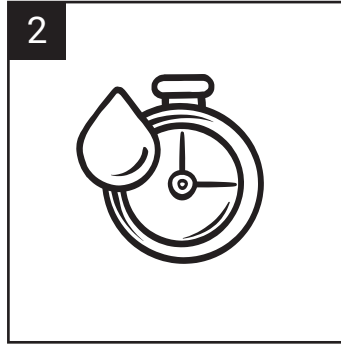

2 Allow to dry completely.

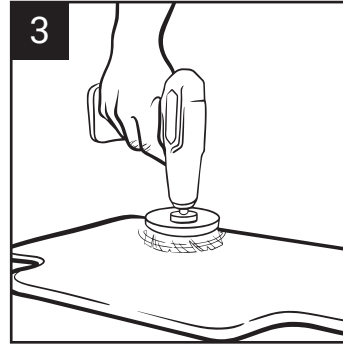

3 Brush the carpet with a nylon bristle brush.

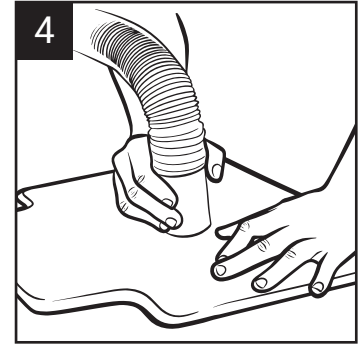

4 Vacuum thoroughly.

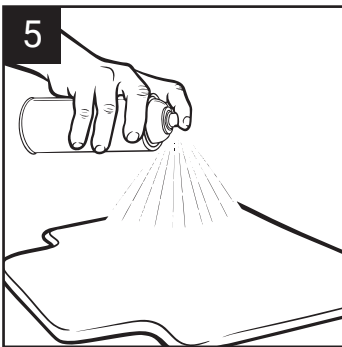

5 Apply desired Colorbond topcoat.

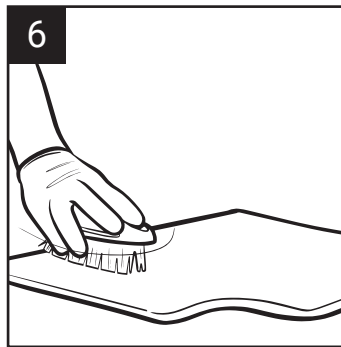

6 Shake the can at least one minute after rattle is heard and occasionally during use.

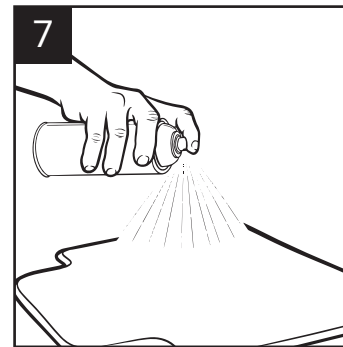

7 Distance: 10-12"  
Coats: 2-3  
Flash time: 5 min.  
Dry time: 30 min.

If clogging develops or to clear spray tip for further use, turn the can upside down and spray for 3 seconds.

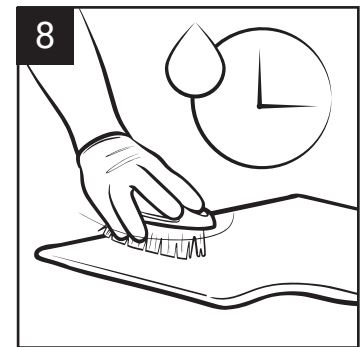

8 Brush carpet after application of each coat immediately to soften the carpet fibers and then allow to dry.

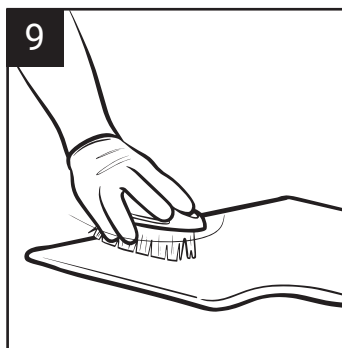

9 After each coat has dried, brush the carpet again.

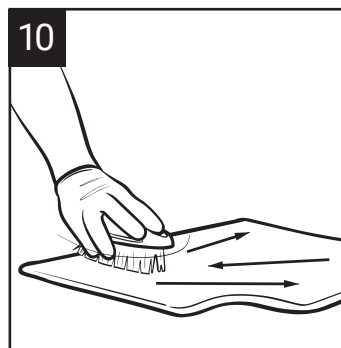

10 After the final coat has dried completely, brush in all directions and vacuum.



It is not recommended to change the color of velour or carpet drastically. It is only recommended to re-fresh a color. **DO NOT** use the same carpet brush for different colors, as this can change the color appearance.

# LVP LEATHER SUBSTRATES



Watch Video

## Application Instructions

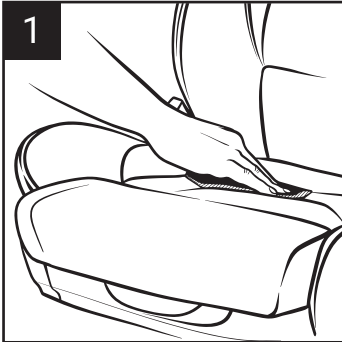

Clean with a small amount of scuffing paste and a gray scuff pad.

(Do not allow scuffing paste to accumulate on the stitching, as it can be difficult to remove completely)

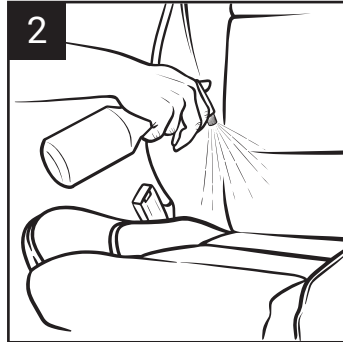

Rinse thoroughly with clean water to remove all soap residue and dry with a clean lint free cloth.

(Scuffing paste residue must be removed completely before top coating. Failure to do so may result in loss of adhesion)

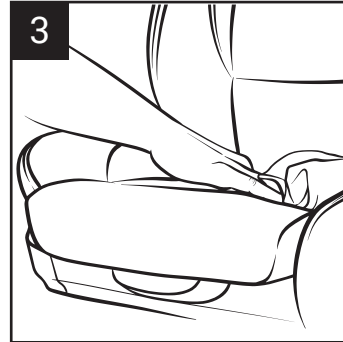

Clean with Colorbond Prep Cleaner and wipe with a clean lint free cloth.

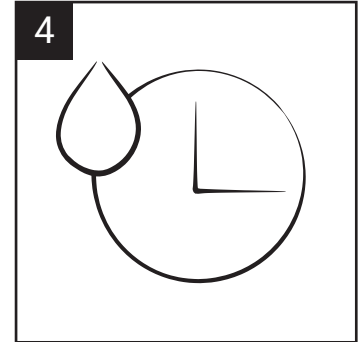

Allow the surface to dry completely.

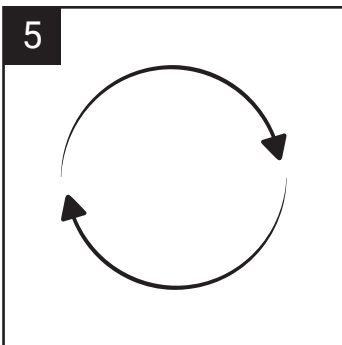

If necessary, repeat the steps above until the surface is completely clean.

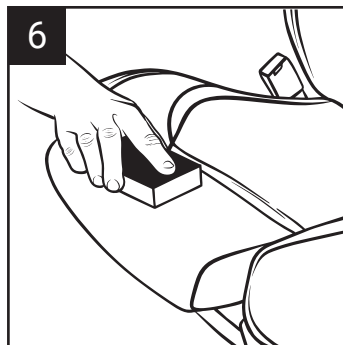

Lightly dry sand the leather with P600 -1000 grit sandpaper

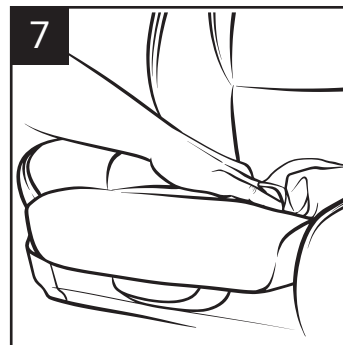

Clean with 70% isopropyl alcohol and a clean lint free cloth.

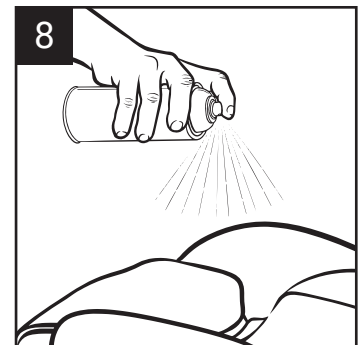

Apply desired Colorbond topcoat

(The application of an adhesion promoter on leather substrates is not recommended.)



Follow safety and usage instructions on the product label. For more product information please refer to the product TDS.

# LVP+ PLASTIC SUBSTRATES



Watch Video

## Application Instructions

If the substrate contains mildew. Use a solution of 10 parts water to 1 part bleach to remove the mildew first.

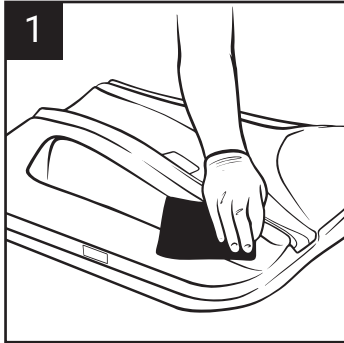

1  
Clean with a scuffing paste and a gray scuff pad.

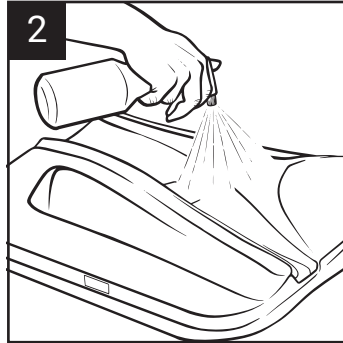

2  
Rinse thoroughly with clean water to remove all residue and dry with a clean lint free cloth. (Scuffing paste residue must be removed completely before top coating. Failure to do so may result in adhesion failure)

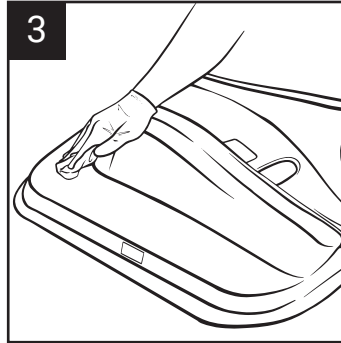

3  
Clean with Colorbond Prep Cleaner and wipe with a clean lint-free cloth.

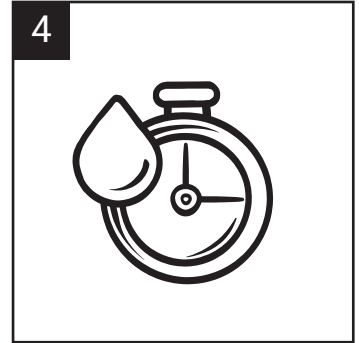

4  
Allow the surface to dry completely.

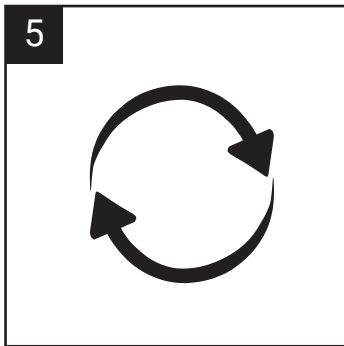

5  
If necessary, repeat the steps 1-4 above until the surface is completely clean.

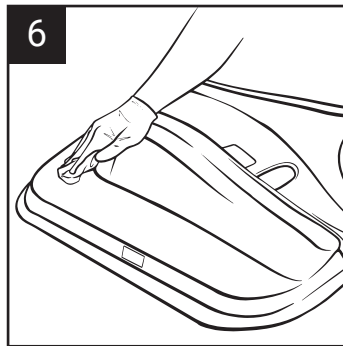

6  
Clean with 70% isopropyl alcohol and wipe with a clean lint-free cloth.

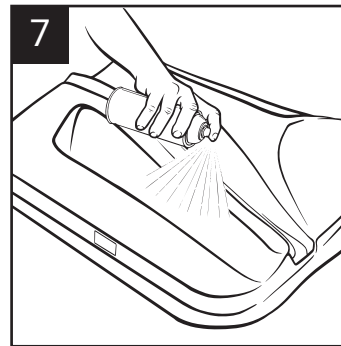

7  
If using raw thermoplastic substrates, apply a coat of Seymour PBE adhesion promoter.

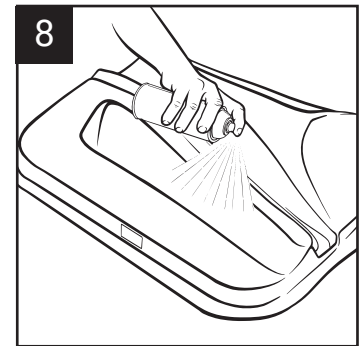

8  
Apply desired Colorbond finish.

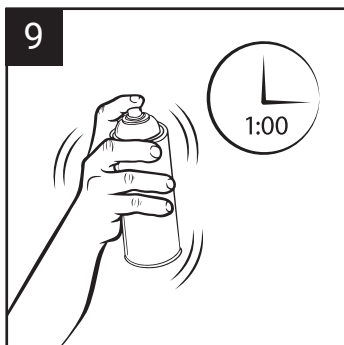

9  
Shake the can at least one minute after rattle is heard and occasionally during use.

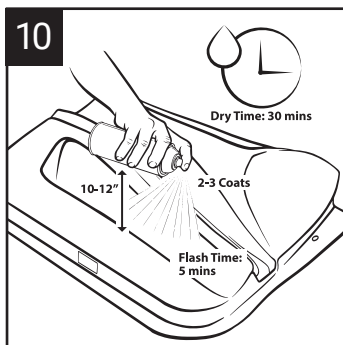

10  
Distance: 10-12"  
Coats: 2-3  
Flash time: 5 min.  
Dry time: 30 min.

If clogging develops or to clear spray tip for further use, turn the can upside down and spray for 3 seconds.

# LVP VINYL SUBSTRATES



Watch Video

## Application Instructions

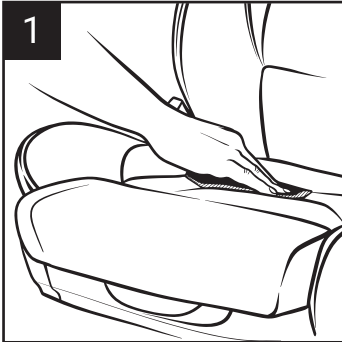

Clean with a small amount of scuffing paste and a gray scuff pad.

(Do not allow scuffing paste to accumulate on the stitching, as it can be difficult to remove completely.)

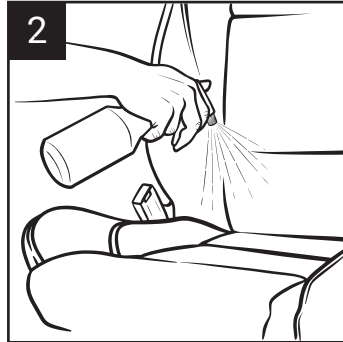

Rinse thoroughly with clean water to remove all soap residue and dry with a clean lint free cloth.

(Scuffing paste residue must be removed completely before top coating. Failure to do so may result in loss of adhesion)

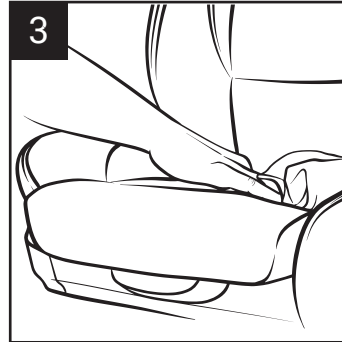

Clean with Colorbond Prep Cleaner and wipe with a clean lint free cloth.

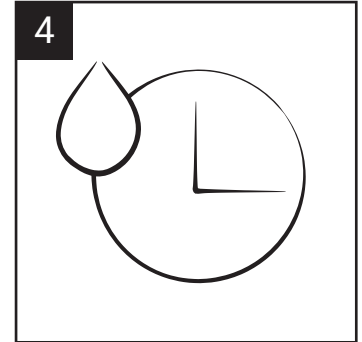

Allow the surface to dry completely.

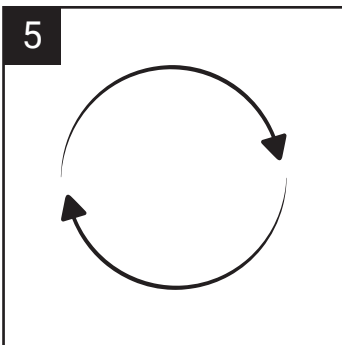

If necessary, repeat the steps above until the surface is completely clean.

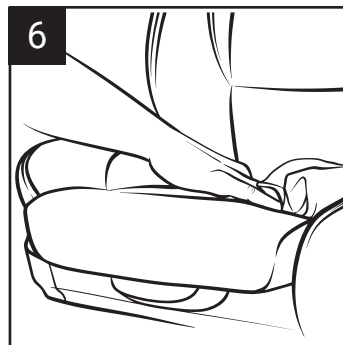

Clean with 70% isopropyl alcohol and a clean lint free cloth.

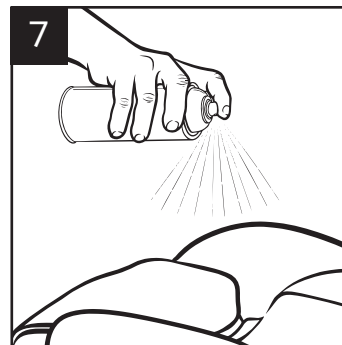

Apply desired Colorbond topcoat.



The application of an adhesion promoter on vinyl substrates is not necessary.