

DIMENSIONS

- A .595"
- B 7/8" HEX
- C ϕ .960"
- D ϕ .469"
- F ϕ .860" BEFORE KNURL
- * G 30 DEG.
- H 30° CHAMF. TO DIA. .860"
(TYP. BOTH SIDES OF HEX)
- * J ϕ .700" X .465" DP.
- K .220"
- * R .062"
- * T 3/4"-20 UNEF 2B THREAD

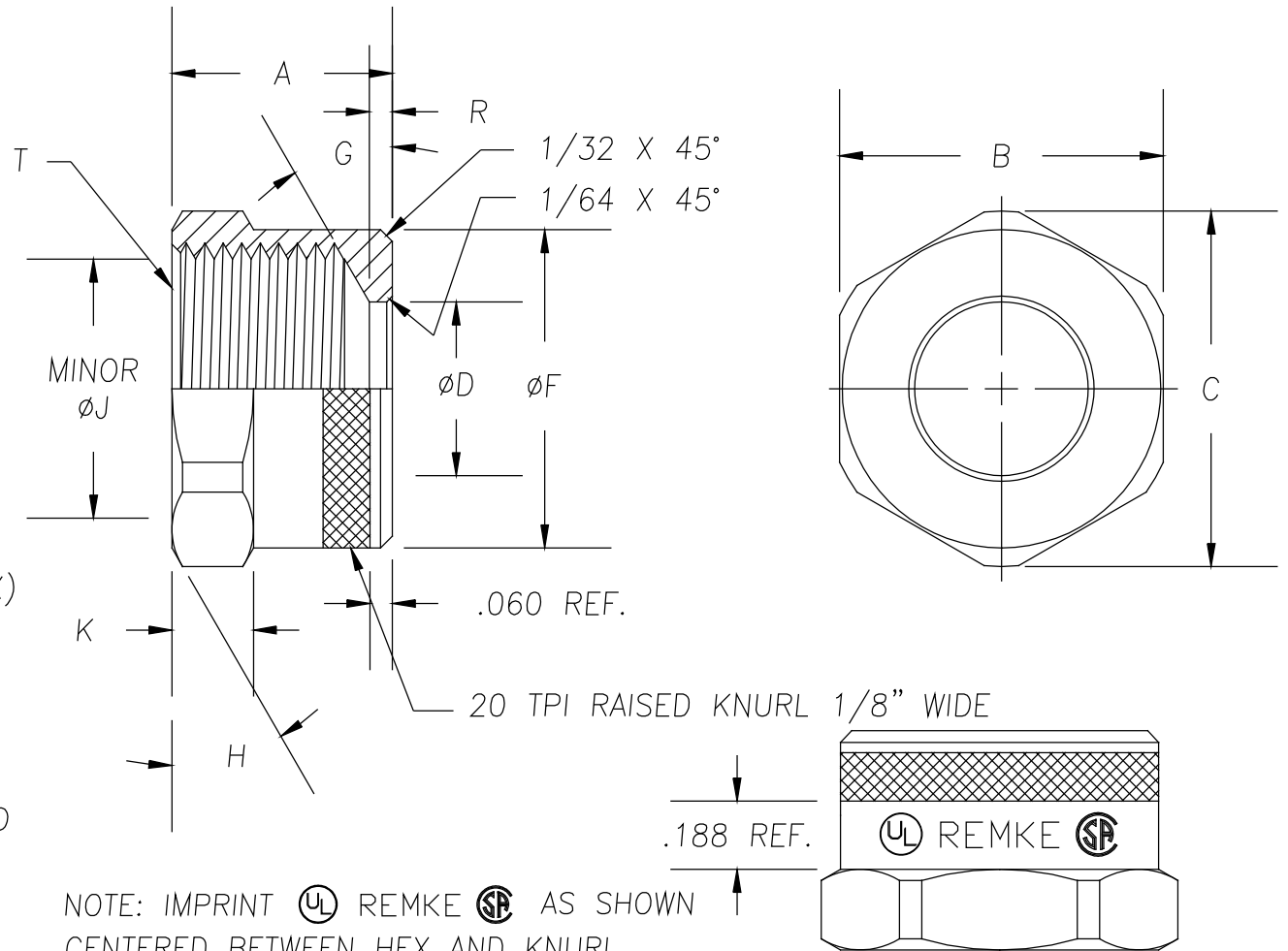

NOTE: IMPRINT REMKE AS SHOWN
 CENTERED BETWEEN HEX AND KNURL
 CHARACTER HEIGHT TO BE 7/64" (SAME PRINTING TOOL FOR RSR-100-N)

NOTES:

- 1.) PART TO BE FREE OF BURRS AND SHARP CORNERS
 PARTICULARLY @ BORE "D"
- 2.) * INDICATES CRITICAL INSPECTION DIMENSIONS

REV.	DATE	CHANGE	
A	5/4/93	CHANGED TO HEX BAR STOCK	UNLESS OTHERWISE SPECIFIED 3-PLC. DIM. +/-.005 2-PLC. DIM. +/-.010 1-PLC. DIM. +/-.015 FRACTIONAL +/-.1/64 ANGULAR +/-.1°
B	11/6/95	CHANGED ϕ C TO .960" & "J" BORE TO .700"	
C	4/21/11	REDRAWN 2:1 SCALE AND ADDED IMPRINTING OF UL, REMKE AND CSA [C.V.]	

REMKE INDUSTRIES
 Wheeling, Illinois 60090

SCALE: 2:1
 MATERIAL: ALUMINUM 6462T6511
 FINISH: MACHINED
 PART NAME: NUT IMPRINTED
 PART NUMBER: RSR-000-N
 DRAWING DATE: 810715