

Delta View

A training table with a gas lift hideaway monitor system. Single and dual workstations available.

Single Unit



Dual Unit



Delta View

A training table with a gas lift hideaway monitor system. Single and dual workstations available.

- Easy to operate gas assisted monitor lift
- No powered required for monitor lift
- Integrated storage & cable management
- Removable access panels
- Monitor Compatibility: fits VESA 75mm and 100mm hole patterns
- If using iMac computers, adapter brackets or product customizations may be required. Please connect with customer service to discuss further
- Utilizes quick connect monitor bracket to easily attach your monitor to the height adjustable column
- Daisy chain power between units (ECA power options avail. upon request)
- Adjustable foot glides included
- Casters available as add-on
- Riser glides avail. as add-on. Increases table height by 2.5"
- Non-Locking and Locking (keyed alike) version avail. - lock is positioned on the top access door of the unit.
- Additional lock kit for the access panel located on the user-side available as add-on
- Additional options include: in-worksurface power, cpu holders
- Custom sizes available
- Steel Guage: 16 GA (legs and feet)
- Where it's made: USA
- Materials: powder coated steel, thermally fused laminate
- Height: 29" (from feet glides to top of 1.125" worksurface)

Part # Breakdown / How to Specify & Order

Specify Delta View part #, and include the base finish code and laminate worksurface finish code at the end of that part #

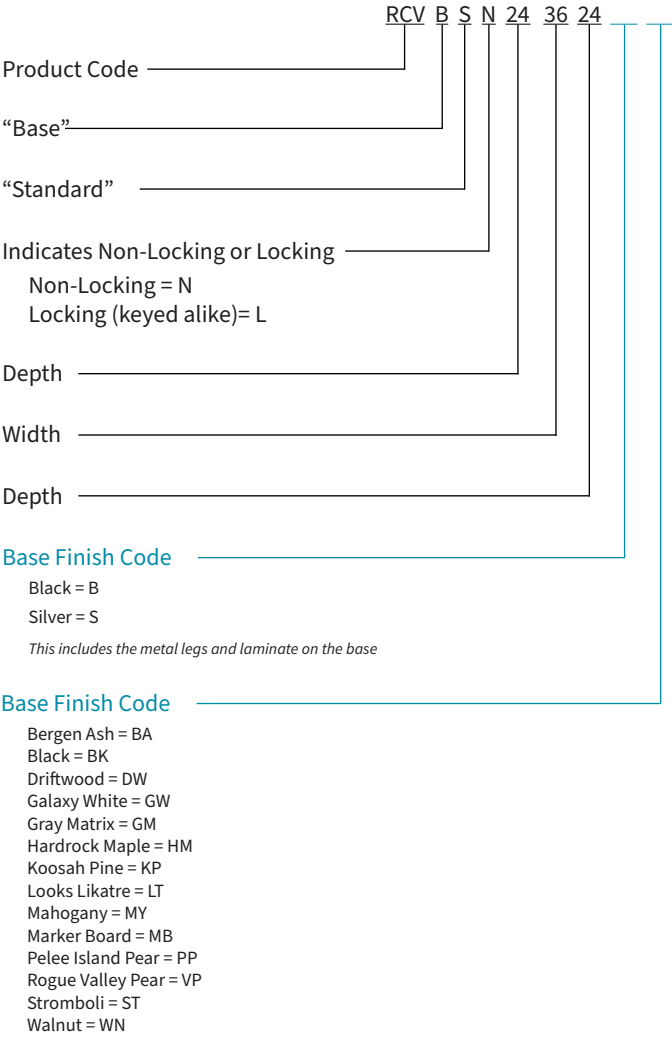

For example, the image above shows # RCVBSN243624SLT.

It is a 24x36 non-locking Delta View with a silver base and looks likatre worksurface.

Accessories, including casters, riser glides, power, etc., are specified separately

Delta View

A training table with a gas lift hideaway monitor system. Single and dual workstations available.

Single Unit

| Part # | Product Description |
|--------------|---|
| RCVBSN243624 | Delta View 24x36x24 Workstation with (1) Vertical Gas Monitor Lift, Non-Locking |
| RCVBSN303630 | Delta View 30x36x30 Workstation with (1) Vertical Gas Monitor Lift, Non-Locking |
| RCVBSL243624 | Delta View 24x36x24 Workstation with (1) Vertical Gas Monitor Lift, Locking (Keyed Alike) |
| RCVBSL303630 | Delta View 30x36x30 Workstation with (1) Vertical Gas Monitor Lift, Locking (Keyed Alike) |
| RCVBSN244824 | Delta View 24x48x24 Workstation with (1) Vertical Gas Monitor Lift, Non-Locking |
| RCVBSN304830 | Delta View 30x48x30 Workstation with (1) Vertical Gas Monitor Lift, Non-Locking |
| RCVBSL244824 | Delta View 24x48x24 Workstation with (1) Vertical Gas Monitor Lift, Locking (Keyed Alike) |
| RCVBSL304830 | Delta View 30x48x30 Workstation with (1) Vertical Gas Monitor Lift, Locking (Keyed Alike) |

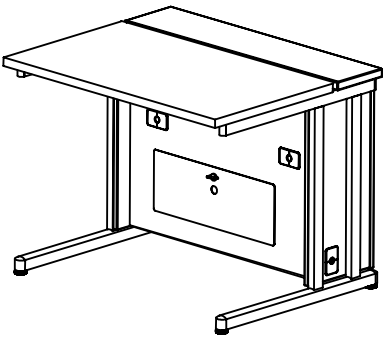

Dimensions

| Size | Dim A | Dim B | Dim C | Dim D | Dim E | Dim F | Dim G |
|---------|-------|--------|---------|-------|-------|--------|--------|
| 24 x 36 | 24" | 35.75" | 15.175" | 12.8" | 14" | 32.52" | 15.76" |
| 24 x 48 | 24" | 47.75" | 15.175" | 18.8" | 14" | 44.52" | 21.76" |
| 30 x 36 | 30" | 35.75" | 21.175" | 12.8" | 20" | 32.52" | 15.76" |
| 30 x 48 | 30" | 47.75" | 21.175" | 18.8" | 20" | 44.52" | 21.76" |

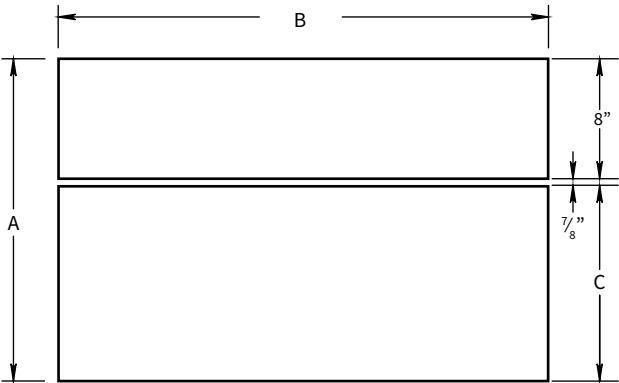

| Size | Max. Monitor Width (left to right) | Max. Monitor Height (top to bottom) | Max. Monitor Depth |
|---------|---------------------------------------|--|-----------------------|
| 24 x 36 | 30.5" | 16" | 4.56" |
| 24 x 48 | 33.5" | 16" | 4.56" |
| 30 x 36 | 30.5" | 16" | 4.56" |
| 30 x 48 | 33.5" | 16" | 4.56" |

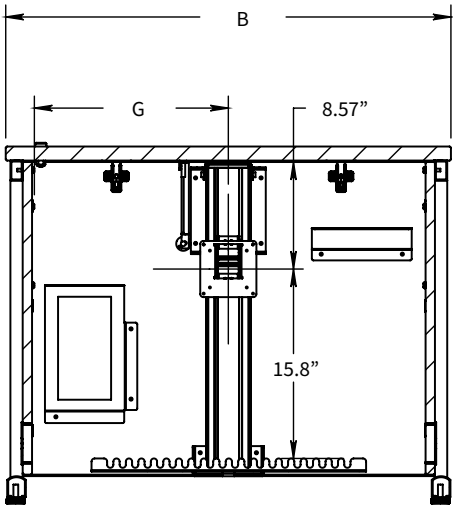
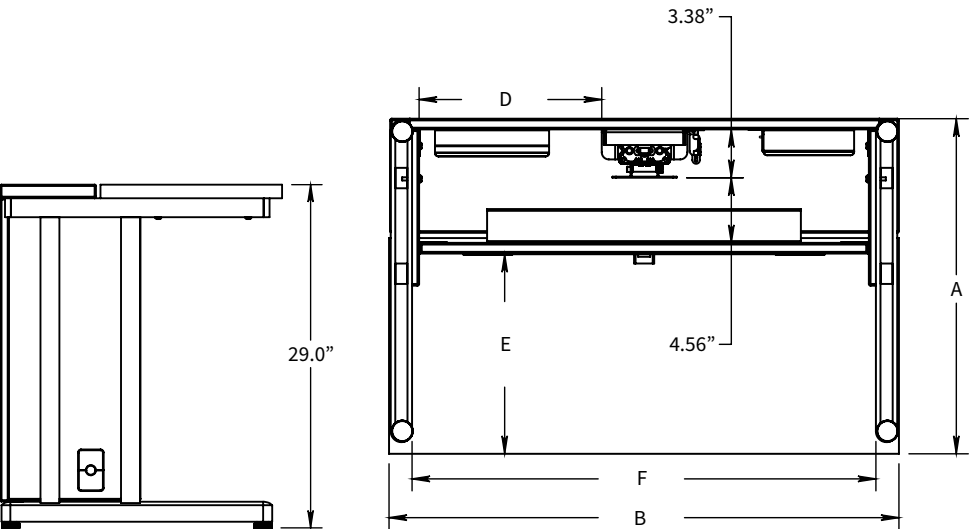

Delta View

A training table with a gas lift hideaway monitor system. Single and dual workstations available.

DUAL Unit

| Part # | Product Description |
|--------------|--|
| RCVBSN246024 | Delta View 24x60x24 Workstation with (2) Vertical Gas Monitor Lifts, Non-Locking |
| RCVBSN306030 | Delta View 30x60x30 Workstation with (2) Vertical Gas Monitor Lifts, Non-Locking |
| RCVBSL246024 | Delta View 24x60x24 Workstation with (2) Vertical Gas Monitor Lifts, Locking (Keyed Alike) |
| RCVBSL306030 | Delta View 30x60x30 Workstation with (2) Vertical Gas Monitor Lifts, Locking (Keyed Alike) |
| RCVBSN247224 | Delta View 24x72x24 Workstation with (2) Vertical Gas Monitor Lifts, Non-Locking |
| RCVBSN307230 | Delta View 30x72x30 Workstation with (2) Vertical Gas Monitor Lifts, Non-Locking |
| RCVBSL247224 | Delta View 24x72x24 Workstation with (2) Vertical Gas Monitor Lifts, Locking (Keyed Alike) |
| RCVBSL307230 | Delta View 30x72x30 Workstation with (2) Vertical Gas Monitor Lifts, Locking (Keyed Alike) |

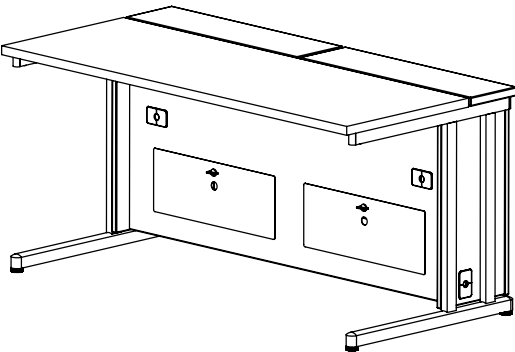

Dimensions

| Size | Dim A | Dim B | Dim C | Dim D | Dim E | Dim F | Dim G | Dim H |
|---------|-------|--------|---------|-------|-------|--------|--------|--------|
| 24 x 60 | 24" | 59.75" | 15.175" | 12.8" | 14" | 32.52" | 15.54" | 29.69" |
| 24 x 72 | 24" | 71.75" | 15.175" | 18.8" | 14" | 44.52" | 21.54" | 35.69" |
| 30 x 60 | 30" | 59.75" | 21.175" | 12.8" | 20" | 32.52" | 15.54" | 29.69" |
| 30 x 72 | 30" | 71.75" | 21.175" | 18.8" | 20" | 44.52" | 21.54" | 35.69" |

| Size | Max. Monitor Width (left to right) | Max. Monitor Height (top to bottom) | Max. Monitor Depth |
|---------|---------------------------------------|--|-----------------------|
| 24 x 60 | 24.25" | 16" | 4.56" |
| 24 x 72 | 30.5" | 16" | 4.56" |
| 30 x 60 | 24.25" | 16" | 4.56" |
| 30 x 72 | 30.5" | 16" | 4.56" |

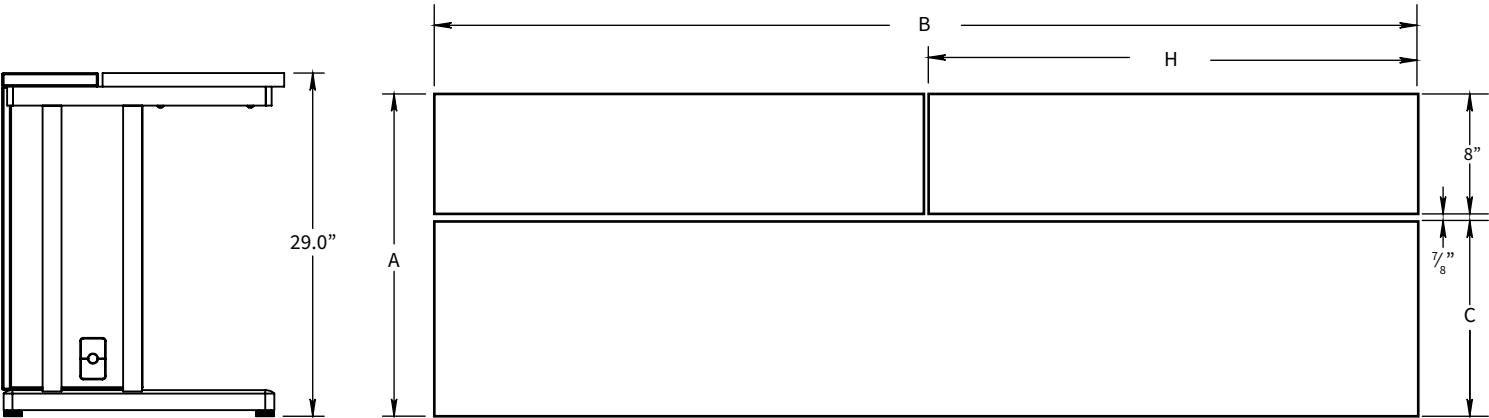

Delta View

A training table with a gas lift hideaway monitor system. Single and dual workstations available.

DUAL Unit

Dimensions

| Size | Dim A | Dim B | Dim C | Dim D | Dim E | Dim F | Dim G | Dim H |
|---------|-------|--------|---------|--------|-------|--------|--------|--------|
| 24 x 60 | 24" | 59.75" | 15.175" | 9.73" | 14" | 56.52" | 12.78" | 29.69" |
| 24 x 72 | 24" | 71.75" | 15.175" | 12.73" | 14" | 68.52" | 15.76" | 35.69" |
| 30 x 60 | 30" | 59.75" | 21.175" | 9.73" | 20" | 56.52" | 12.78" | 29.69" |
| 30 x 72 | 30" | 71.75" | 21.175" | 12.73" | 20" | 68.52" | 15.76" | 35.69" |

| Size | Max. Monitor Width (left to right) | Max. Monitor Height (top to bottom) | Max. Monitor Depth |
|---------|---------------------------------------|--|-----------------------|
| 24 x 60 | 24.25" | 16" | 4.56" |
| 24 x 72 | 30.5" | 16" | 4.56" |
| 30 x 60 | 24.25" | 16" | 4.56" |
| 30 x 72 | 30.5" | 16" | 4.56" |

