



FCM490

Wire Management Spine

- Route cables from desk to floor
- Easily fix to underside of the desk
- Quickly install or remove cables
- Keep cables segregated from each other

DISASSEMBLY

Easy disassembling when required.

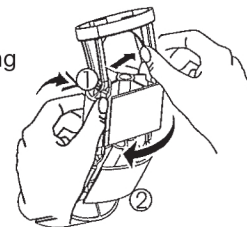

Assembly Guide

Step 1

Fix the top bracket of cable manager under the desk with screwdriver (not provided).

- Suggested thickness: 20mm or above.

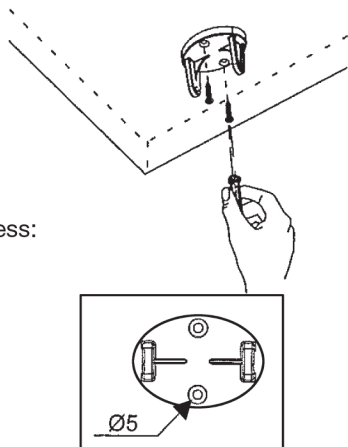

Step 2

Assemble the cable manager and top fixing bracket.

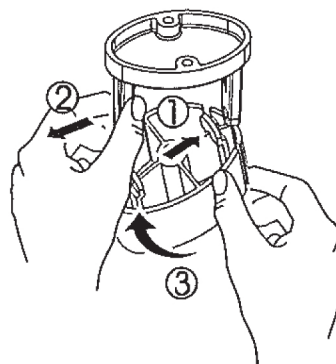

Step 3

Assemble the cable manager and bottom weighted base.

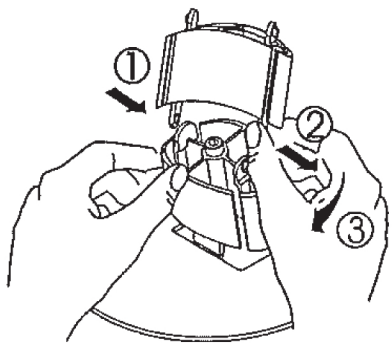

Step 4

Route cables from desk to floor.

