

1. LASER HOUSING
2. AMBIDEXTROUS ON/OFF BUTTONS
3. USB-C CHARGING PORT
4. BATTERY INDICATOR LED
5. ELEVATION ADJUSTMENT
6. WINDAGE ADJUSTMENT
7. MOUNTING SCREW

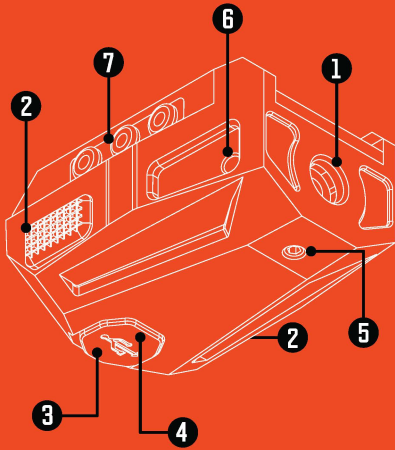

DO NOT SHINE LASER IN EYES.

CAUTION - USE OF CONTROLS OR ADJUSTMENTS OR PERFORMANCE OF PROCEDURES OTHER THAN THOSE SPECIFIED HEREIN MAY RESULT IN HAZARDOUS RADIATION EXPOSURE.

MAINTENANCE
KEEP THE PRODUCT CLEAN AND OCCASIONALLY CHECK FOR PROPER OPERATION.

DO NOT ATTEMPT TO ACCESS LASER.

PRODUCT GUARANTEE
IF YOU EXPERIENCE A PROBLEM, PLEASE DO NOT RETURN TO YOUR LOCAL STORE. PLEASE CONTACT OUR CUSTOMER SERVICE TEAM AT 800-255-6061 OR WWW.IPROTEC.COM

IPROTEC®

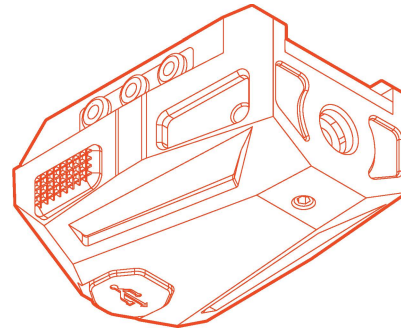

RMSLR

MYCRO RED LASER



PICATINNY /
WEAVER MOUNT

IPR-LSR-0001

CAUTION: ALWAYS REMOVE THE UNIT FROM YOUR FIREARM BEFORE ATTEMPTING ANY MAINTENANCE.

OPERATION

THIS UNIT IS EQUIPPED WITH TWO POWER BUTTONS (2) FOR CONVENIENT, AMBIDEXTROUS USE.

WHILE OFF:

PRESS AGAIN FOR HIGH
PRESS AGAIN FOR LOW
PRESS AGAIN TO TURN OFF

IF IT HAS BEEN LONGER THAN EIGHT SECONDS SINCE THE UNIT HAS BEEN TURNED ON TO ANY MORE, THE NEXT BUTTON PRESS WILL TURN THE UNIT OFF.

MODES

HIGH: FOR BRIGHT, DAYTIME CONDITIONS
RUN TIME: 5 HOURS

LOW: FOR LOW-LIGHT, NIGHT TIME CONDITIONS
RUN TIME: 8 HOURS

BATTERY

WHILE CHARGING, THE BATTERY INDICATOR LED (4) WILL ILLUMINATE TO INDICATE THE BATTERY LEVEL.

RED: CHARGING GREEN: FULLY CHARGED

NOTE: THIS UNIT IS POWERED BY A SINGLE RECHARGEABLE BATTERY THAT IS NOT REPLACEABLE.

MOUNTING

1. LOOSEN THE MOUNTING SCREW (7) ON THE LASER WITH THE INCLUDED ALLEN KEY.

2. PLACE THE MOUNTING SCREW IN ONE OF THE THREE SLOTS ON THE UNIT. LINE UP THE SCREW SHAFT WITH THE DESIRED PICATINNY SLOT ON THE WEAPON AND "SNAP" IT INTO PLACE.

3. ONCE IN PLACE, MAKE SURE THE LASER IS FULLY SEATED ON THE RAIL AND TIGHTEN THE SCREW (7).

4. MAKE SURE YOU CAN REACH THE LASER TO ACTIVATE IT AND THAT THE CONTROLS OPERATE PROPERLY.

CAUTION: MAKE SURE THAT THE FIREARM HAS THE SAFETY ON AND IS UNLOADED TO AVOID UNINTENTIONAL DISCHARGE. MAKE SURE THE MOUNT IS SECURE AND TEST YOUR LASER FOR PROPER FUNCTIONALITY.

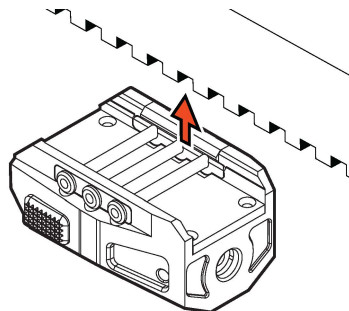

NOTE: BEFORE YOU BEGIN FINE-TUNING THE LASER, HAVE THIS USER MANUAL ON HAND TO REFERENCE THE ELEVATION (5) AND WINDAGE (6) SIGHT SCREWS.

WINDAGE AND ELEVATION

1. SECURE THE UNIT FIRMLY IN PLACE ON THE ACCESSORY RAIL WITHOUT ALLOWING ANY MOVEMENT. REFER TO "MOUNTING INSTRUCTIONS" SECTION OF THIS MANUAL FOR PROPER MOUNTING.

2. FOR BEST ACCURACY, ZERO IN YOUR LASER FROM A FIXED RESTING POSITION WHILE INTERMITTENTLY ADJUSTING THE LASER.

3. KEEPING IN MIND, AT 15, 20, AND 25 FEET, THE PATH OF THE LASER REMAINS LEVEL. AS THE DISTANCE INCREASES, YOU WILL BE FARTHER OFF TARGET. SIGHT THE LASER IN AT 25 FEET. THE LASER'S POINT OF IMPACT SHIFT WILL BE MORE GRADUAL, AND EVEN AT CLOSE RANGE YOU WON'T BE MORE THAN AN INCH OR SO OFF TARGET.

4. FINE-TUNE LASER BY MAKING VERY SMALL ADJUSTMENTS TO ELEVATION AND WINDAGE SCREWS USING INCLUDED HEX WRENCH.

