

DIMENSIONS

- A 1.43
- B 1.6
- C .59
- D .62
- F 1" NPT THREAD \*
- G 1 3/8"-16 THREAD \*
- "GO" P.D.= 1.3300"
- "NO GO" P.D.= 1.3250"
- \* RUN TH'D TO FREE FIT

\* MACHINE BENEATH HEX TO ACHIEVE LENGTH "D"

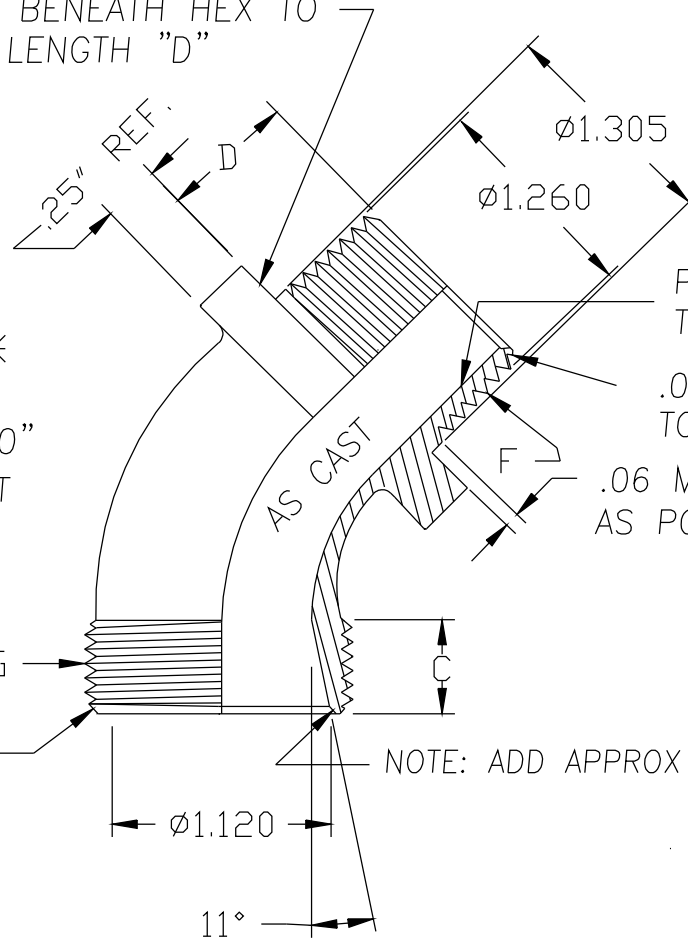

PARTIAL CLEAN-UP PERMISSIBLE TO ELIMINATE FLASH (BOTH ENDS)

.03 X 45° APPROX. AND FACE OFF FIRST TO ELIMINATE FLASH

.06 MAX.—MACHINE THREAD AS CLOSE AS POSSIBLE BENEATH HEX \*

\* .03 X 45° APPROX. FACE OFF FIRST TO ELIMINATE FLASH

\* CRITICAL DIMENSIONS

**REMKE INDUSTRIES**

Wheeling, Illinois 60090

SCALE: APPROX FULL

MATERIAL: ALUM SAND CAST

FINISH: NATURAL

PART NAME: 45 DEGREE BODY

PART NUMBER: RSR-45300-B

DRAWING DATE: 920212

REV.	DATE	CHANGE	
A	7-2-99	REDRAWN USING CAD	UNLESS OTHERWISE SPECIFIED 3-PLC. DIM. +/.005 2-PLC. DIM. +/.010 1-PLC. DIM. +/.015 FRACTIONAL +/1/64 ANGULAR +/°1
B	8/16/06	REDRAWN & REDIMENSIONED	
C	8/12/10	DIM. ".26" HEX THICKNESS IS NOW .25' REF. AND ADDED BOLD NOTES FOR CLARIFICATION.	
		AND ELIMINATED DIM. "E" 1.03 X .81 DP. CV	