

kanto 

English
User Manual
REN

HDMI[®]
HIGH-DEFINITION MULTIMEDIA INTERFACE

 **Bluetooth**[®]

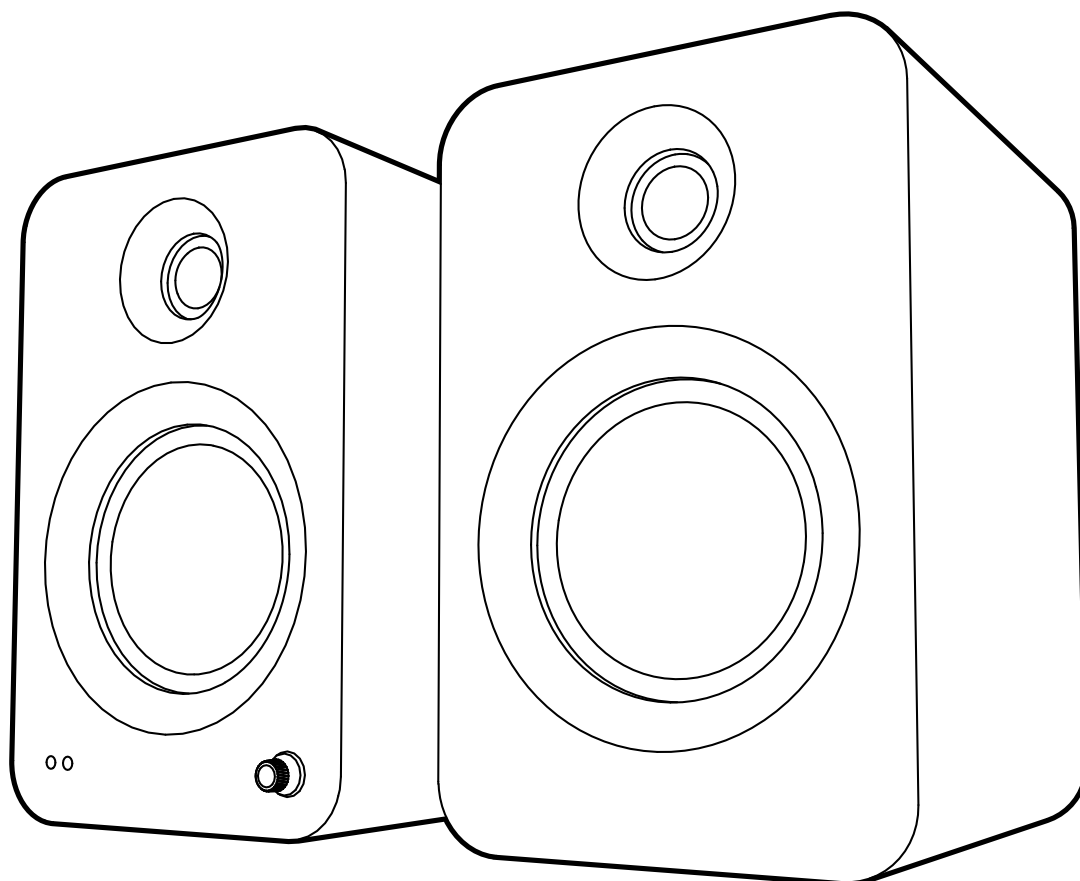

REN

POWERED SPEAKER SYSTEM

Supporting your digital lifestyle™

Important Safety Precautions



ATTENTION

The exclamation point within an equilateral triangle is intended to alert the user of the presence of important operating and maintenance (servicing) instructions in the literature accompanying the apparatus.

CAUTION RISK OF ELECTRIC SHOCK DO NOT OPEN

CAUTION: TO REDUCE THE RISK OF ELECTRIC SHOCK, DO NOT REMOVE BACK PANEL. NO USER SERVICEABLE PARTS INSIDE. REFER SERVICING TO QUALIFIED SERVICE PERSONNEL.



DANGEROUS VOLTAGE

The lightning flash with arrowhead, within an equilateral triangle, is intended to alert the user of the presence of non-insulated "dangerous voltage" within the product's enclosure that may be of sufficient magnitude to constitute a risk of electric shock to persons.

- Read these instructions.
- Keep these instructions.
- Heed all warnings.
- Follow all instructions.
- Do not use this apparatus near water.
- Clean only with a dry cloth.
- Do not block any ventilation openings. Install in accordance with the manufacturer's instructions.
- Do not install near any heat sources such as radiators, heat registers, stoves, or other apparatus (including amplifiers) that produce heat.
- Protect the power-supply cord from being walked on or pinched, particularly at plugs, convenience receptacles and the point where they exit from the apparatus.
- Only use attachments / accessories specified by the manufacturer.
- Use only with the cart, stand, tripod, bracket, or table specified by the manufacturer, or sold with the apparatus. When a cart is used, use caution when moving the cart / apparatus combination to avoid injury from tip-over.
- Unplug this apparatus during lightning storms or when unused for long periods of time.
- Refer all servicing to qualified service personnel. Servicing is required when the apparatus has been damaged in any way, such as power-supply cord or plug is damaged, liquid has been spilled or objects have fallen into the apparatus, the apparatus has been exposed to rain or moisture, the apparatus does not operate normally, or the apparatus has been dropped.
- Apparatus shall be connected to a MAINS socket outlet with a protective earthing connection.
- An appliance input coupler is used as the disconnect device - the disconnect device shall remain readily operable.
- Batteries or battery packs shall not be exposed to excessive heat such as sunshine, fire or the like.

FCC Notice:

This device complies with part 15 of the FCC Rules. Operation is subject to the following two conditions: (1) this device may not cause harmful interference, and (2) this device must accept any interference received, including interference that may cause undesired operation.

This equipment complies with FCC radiation exposure limits set forth for an uncontrolled environment. This equipment should be installed and operated with minimum distance 20cm between the radiator and your body.

NOTE 1:

This equipment has been tested and found to comply with the limits for a Class B digital device, pursuant to part 15 of the FCC rules. These limits are designed to provide reasonable protection against harmful interference in a residential installation. This equipment generates, uses and can radiate radio frequency energy and, if not installed and used in accordance with the instructions, may cause harmful interference to radio communications. However there is no guarantee that interference will not occur in a particular installation. If this equipment does cause harmful interference to radio or television reception, which can be determined by turning the equipment off and on, the user is encouraged to try to correct the interference by one or more of the following measures:

- Reorient or relocate the receiving antenna
- Increase the separation between the equipment and receiver
- Connect the equipment into an outlet on a circuit different from that to which the receiver is connected
- Consult the dealer or an experienced radio / TV technician for help

NOTE 2:

Any changes or modifications to this unit not expressly approved by the party responsible for compliance could void the user's authority to operate the equipment.

Industry Canada Notice:

This radio transmitter had been approved by Industry Canada. This Class B digital apparatus complies with the Canadian standard ICES-003. This device complies with Industry Canada License exempt RSS standard(s). Operation is subject to the following two conditions: (1) this device may not cause interference and (2) this device must accept any interference, including interference that may cause undesired operation of the device.

This equipment complies with ISED radiation exposure limits set forth for an uncontrolled environment. This equipment should be installed and operated with minimum distance 20cm between the radiator & your body.

Table of Contents

Important Safety Precautions	2
Introduction	4
What's in the Box?	4
Front & Rear Panels	5
Remote Control	6
Setting up REN	7
Connecting to a TV	9
Connecting to a Smart Home Device or Network Streamer	10
Connecting to a Computer	11
Connecting to a Turntable.	11
Connecting Bluetooth®	12
Connecting a Subwoofer	13
Special Functions	14
Audio Troubleshooting Guide	15
Limited Warranty to Original Purchaser	16



 www.kantoaudio.com

 1-888-848-2643

 support@kantoliving.com

 kantoaudio.com/powered-speakers/ren/
Find product resources online
Trouvez des ressources sur les produits en ligne
Encuentre recursos de productos en línea

MANUFACTURER AND IMPORTER:
Kanto Living Inc., 9136 196A Street, Langley, BC, Canada V1M 3B4

Introduction

Thank you for choosing REN, a Canadian designed powered speaker system. Combining the simplicity of a soundbar with the accuracy of a DSP-controlled stereo system, REN seamlessly integrates with any modern TV via HDMI®ARC, delivering a home theater-like experience in one streamlined package. REN tackles the frustration of quiet dialogue and overwhelming sound effects with two sound modes that boost vocals and reduce low frequencies for nighttime viewing. When it's time to add a subwoofer, REN automatically filters sub-bass from its 5.25" aluminum woofers, letting them focus on midrange frequencies with minimal distortion. REN offers versatility beyond the living room with Bluetooth® 5.3 wireless technology for smart home devices, optical for WiFi network streamers, USB-C for desktop use, and analog inputs for everything else.

We recommend you read all instructions carefully before using REN and keep them for future reference. Kanto cannot be liable for damage or injury caused by incorrect setup or use of this product.

REN was carefully tested and inspected during production, and before packaging and shipping. After unpacking, please check for any damage. It is rare that a unit is damaged during shipping, but if this happens contact your retailer immediately. You can also contact Kanto directly using one of the methods listed on page 3.

What's in the Box?

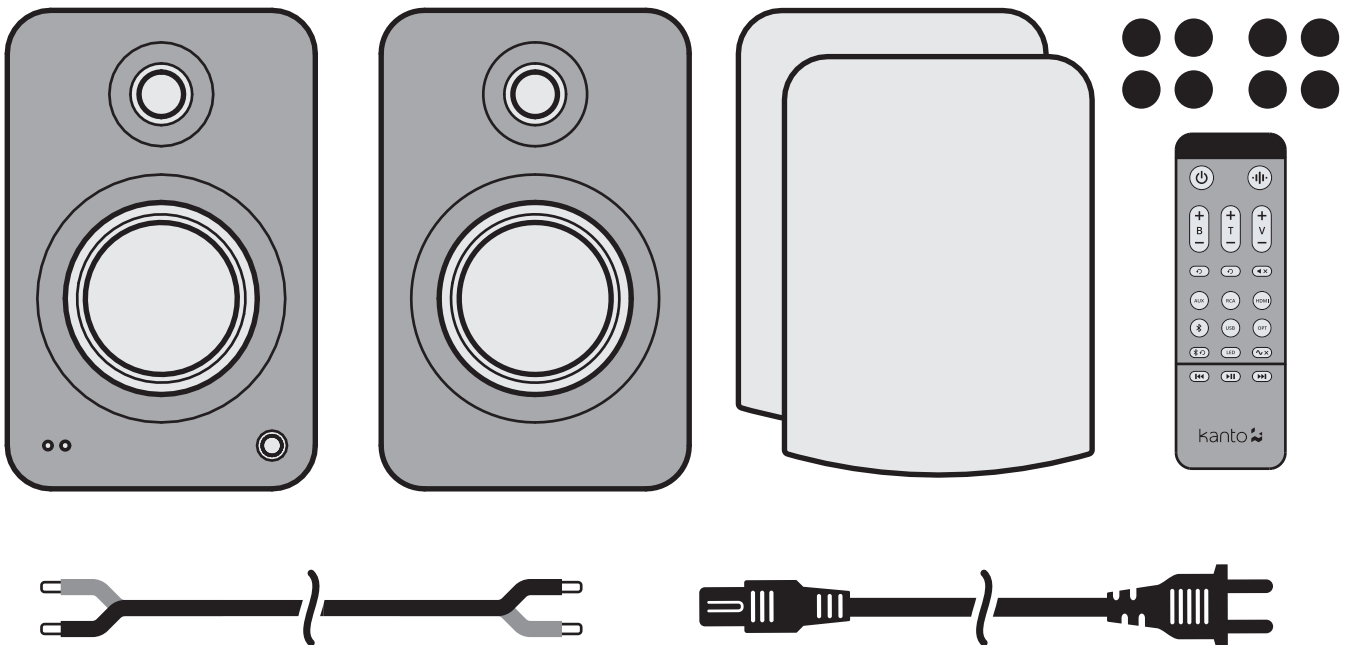

Front & Rear Panels

- 1 1" silk dome
- 2 5.25" aluminum concave cone
- 3 Control Knob
- 4 LED
 - Teal - AUX
 - Green - RCA
 - Purple - HDMI® ARC
 - Pink - Optical
 - Yellow - USB
 - Blue - Bluetooth Pairing (flashing)
 - Blue - Bluetooth Paired (solid)
- 5 IR Receiver

REN's control knob can be used to adjust volume, cycle through inputs, or bring the speaker in and out of standby.

Push the knob to select an input source - it cycles through the following inputs depending on what input source was last used.

AUX → RCA → HDMI® ARC → OPTICAL → USB → BLUETOOTH®

Push and hold the knob to enter standby or wake up from standby.

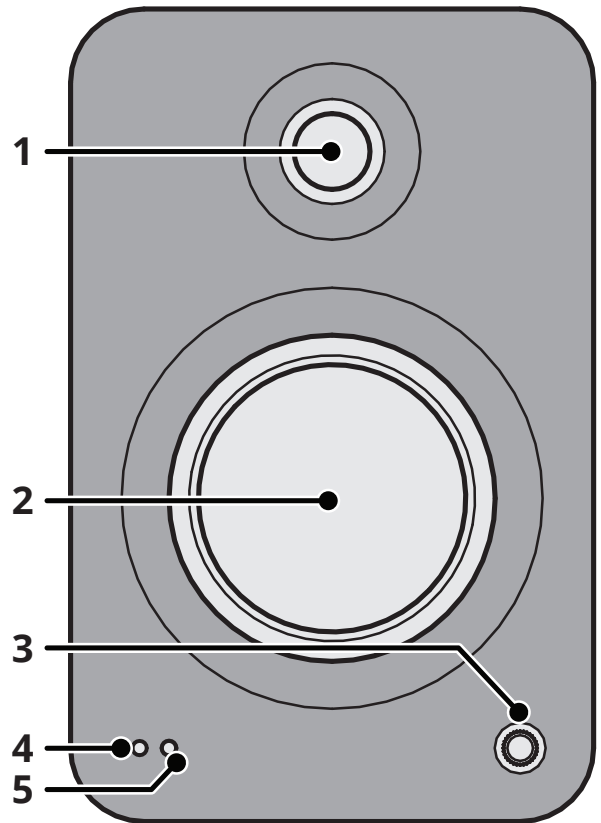

- 6 Bass Reflex Port
- 7 USB Charge Port (5 V / 1 A)
- 8 Subwoofer Out
- 9 Inputs
 - AUX
 - RCA
 - Optical
 - HDMI® ARC
 - USB-C
- 10 Output Terminals (+ and -) for Passive Speaker Connection
- 11 AC Input Connection (100 V - 240 V)
- 12 On / Off Switch

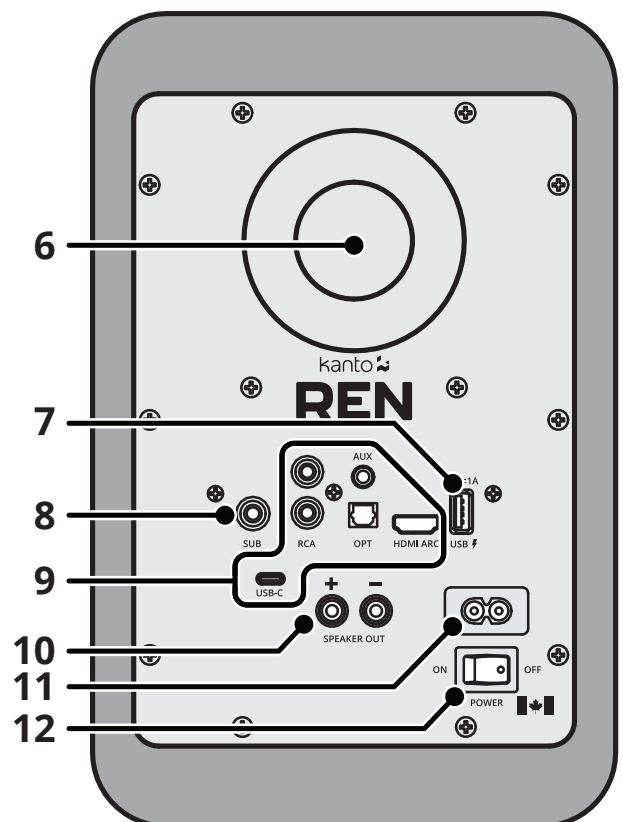

Remote Control

Install two AAA batteries in the back of your REN remote. Remote Control functions are listed below.

1 Standby / Wake

2 Sound Modes

3 Bass Adjust

4 Treble Adjust

5 Volume Adjust

6 Bass Reset

7 Treble Reset

8 Mute

9 AUX

10 RCA

11 HDMI® ARC

12 Bluetooth®

13 USB

14 Optical

15 Bluetooth® Reset

16 LED Brightness Adjust

17 Sub

18 Previous Track

19 Play / Pause

20 Next Track

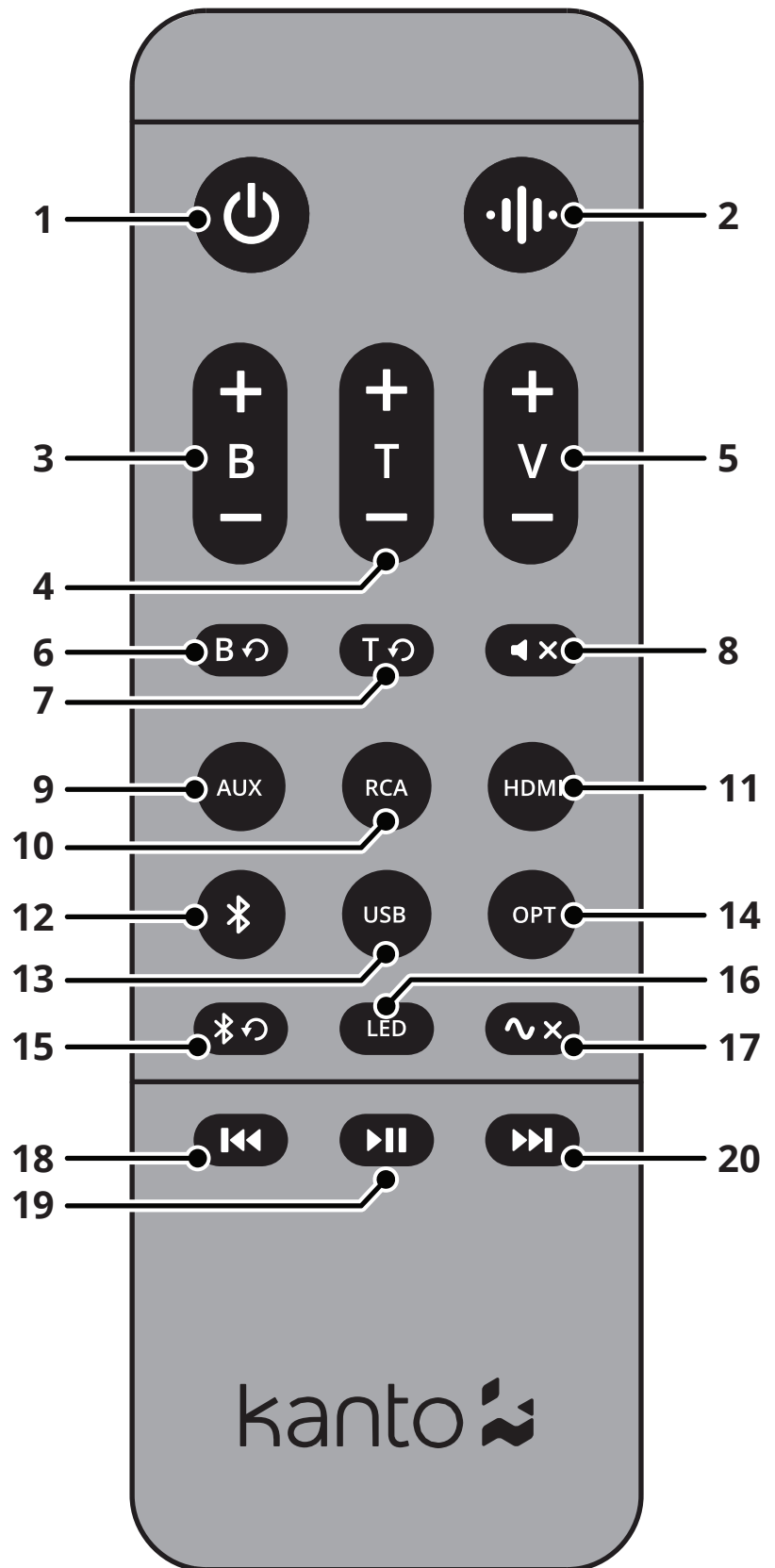

Setting up REN

Ensure that the Power Switch is in the OFF position.

Connect the two speakers together as shown below using the supplied speaker cable. Connect the RED (+) and BLACK (-) terminals from the active speaker to the corresponding terminals on the passive speaker. If you wish to place your speakers farther apart than the supplied cable will reach, we recommend that you purchase a heavier gauge of speaker cable to minimize signal loss.

Connect the AC power cord from REN's active speaker to your wall outlet. Turn the Power Switch to ON once all the inputs have been plugged in.

REN is designed to perform optimally when positioned at least 8" from the rear wall in an average listening room. However, it may not be possible to install the speaker in this position and since rooms vary in shape, size, and furnishing, a certain amount of experimentation is necessary to determine the most suitable position. Moving the speaker very close to the rear wall will enhance the bass frequencies but will tend to reduce soundstage depth, while moving the speaker away from the rear wall will tend to have the opposite effect. Avoid positioning the speaker close to or in the corner of a room, as this will excite undesirable room coupling in the low and middle frequencies. Room characteristics and positioning have a profound effect on the performance of the speakers, so time and effort devoted to achieving the optimum positions will be rewarded.

Follow the instructions on the ensuing pages to connect your audio sources to REN.

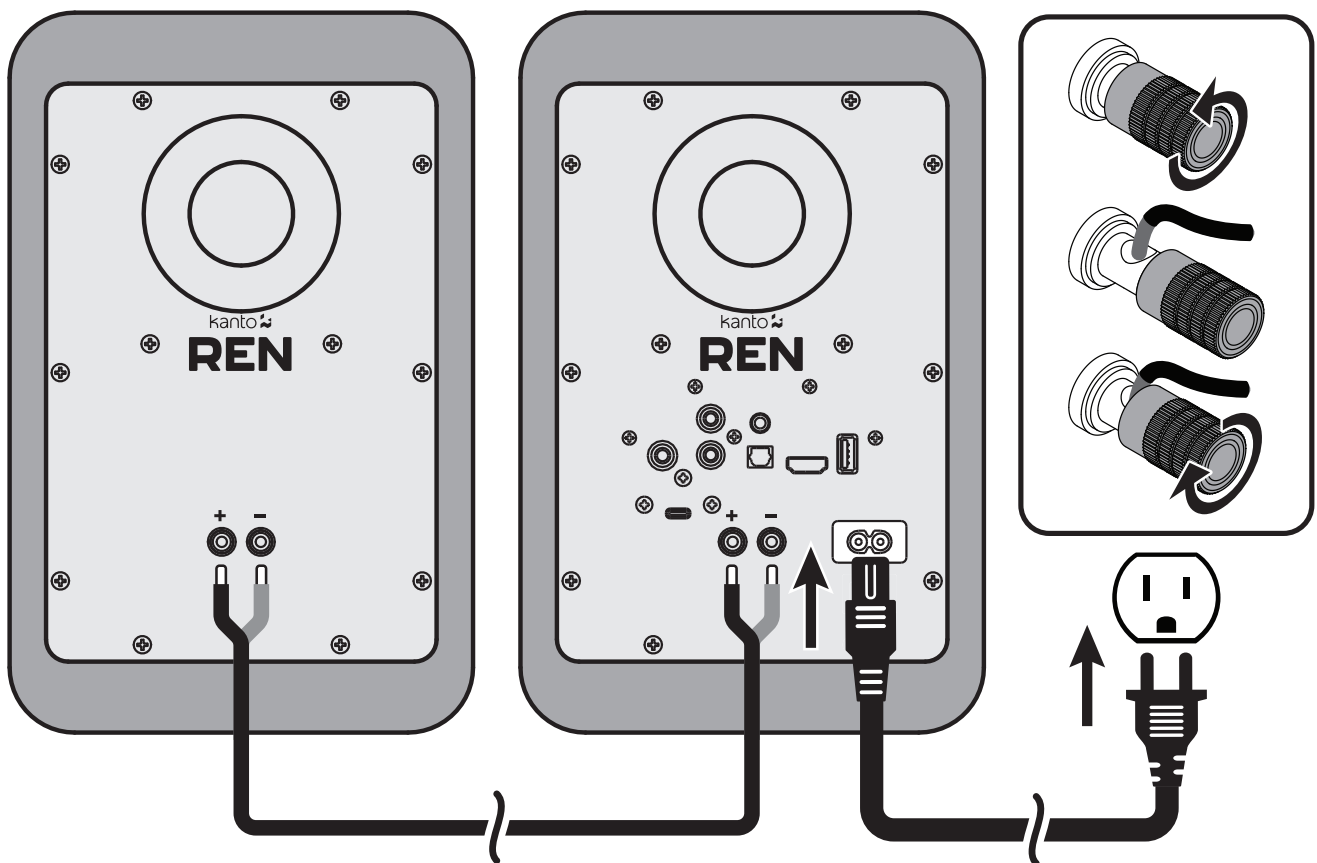

ATTENTION

When connecting audio cables the Power Switch must be turned OFF. After connecting all cables, the unit can be turned ON. When the volume is high, this system can produce noise levels that could permanently damage your hearing. REN is a self-powered speaker system. Do not connect the speaker inputs to the outputs of a stereo amplifier. Damage may occur. Use only the power cord provided with REN.

Setting up REN continued

Start-up / Shut-down time

REN can take up to 6 seconds to boot up and shut down. During this time the speaker will not respond to remote commands or adjustments to the control knob. Do not attempt to adjust any settings while REN is starting up as it may cause a jarring change when audio starts playing.

Channel Swap

You can swap the L / R stereo output on REN. This can be helpful in situations where you want to place your speakers correctly, or need to reach power outlets / inputs, ensuring correct stereo image in any configuration. The active speaker is set to the left channel by default.

To use the active speaker on the right, press and hold the Next Track button for 5 seconds. You will see the LED blink twice to confirm the output is swapped. To use the active speaker on the left, press and hold the Previous Track button for 5 seconds. You will see the LED blink twice to confirm the output is swapped.

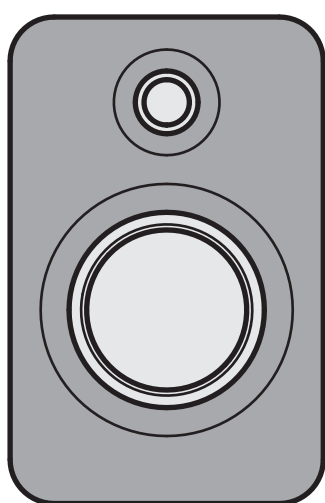

L

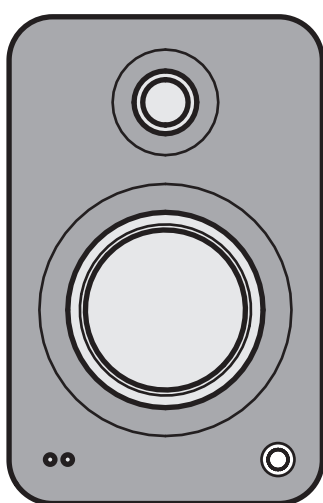

R

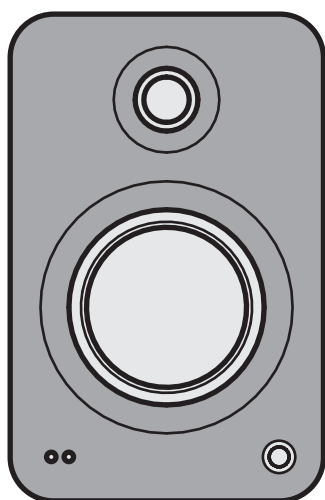

L

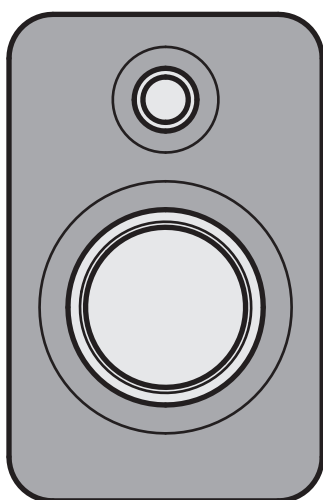

R

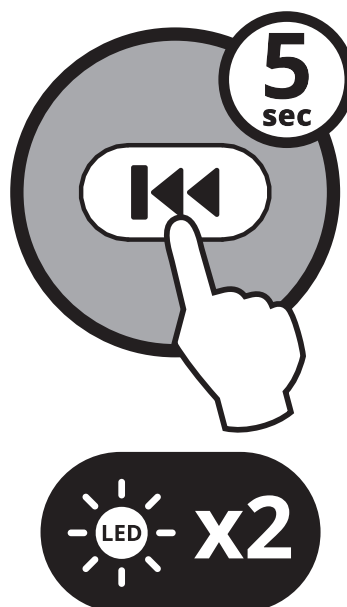

Connecting to a TV

REN features an HDMI® ARC input for use with TVs. Most modern TVs have an HDMI® Audio Return Channel (ARC) Port which can carry either a stereo or surround signal. REN requires a stereo source, and you may have to configure your TV's audio output to stereo instead of surround. Please note the following steps are a general overview – the actual procedure will vary depending on TV brand.

1. While the speakers are in standby or OFF, plug one end of the HDMI® cable into the TV and the other into the HDMI® ARC input of REN.
2. Turn on the TV and navigate to the audio settings within the on-screen menu. Refer to your TV's manual if you are unsure of how to find the audio settings within your TV.
3. Within audio settings, change the audio output to PCM, stereo, or two channel. This option may be called "Audio Output Mode", "Digital Audio Output Mode", or "Digital Output Audio Format" depending on TV brand.
4. Turn ON or wake the speakers and select the HDMI® ARC Input using the REN remote's HDMI button. You can also cycle through inputs by pressing the knob on the front of REN.

After you adjust the volume on the speakers, you should hear the audio from your TV being played through the speakers. If you hear noise, silence, or choppiness you may need to change the audio settings of the TV box, TV app, Blu-ray player, etc. as well. Follow a similar process to navigate to the audio settings of the device or app you are using and switch the audio mode to stereo or two channel. If you still do not hear any audio after making these changes, refer to the Audio Troubleshooting Guide.

Once REN is correctly playing audio you should be able to adjust volume using your TV's remote. Because REN has HDMI® ARC with CEC, the speakers should wake and go into standby when you turn your TV on and off respectively. If you are actively using a different input than HDMI® when your TV is turned on, REN should automatically switch to the HDMI® ARC input. You can always switch to a different input using REN's remote even while the TV is on.

Connecting to a Smart Home Device or Network Streamer

REN features an optical input and Bluetooth® to cover all connection methods a smart home device or network streamer may utilize. Please note the following steps are a general overview – the actual procedure will vary depending on device.

1. Setup your device using the manufacturer's instructions or app. Ensure it is working correctly before trying to connect it to REN.
2. If your device has an audio output, plug one end of the required cable into the device and the other into REN.
3. If your device only has Bluetooth®, refer to the device's instructions or app to complete Bluetooth® setup.
4. Turn ON or wake REN and select the input that your device is connected to using REN's control knob or remote.

After you adjust the volume on the speakers, you should hear the audio from your device being played through the speakers. You have the option to disable the automatic power down feature on REN to prevent the speakers from going into standby so you don't miss any notifications or prompts (see Pg. 14).

If you'd like the speakers to automatically power down while your device is not in use you may want to enable the wake up sound on your device. REN takes several seconds to wake up when it detects audio. Enabling a wake up sound will give the speakers a head start before audio begins streaming from your device. Refer to your device's manual for instructions on how to enable the wake up sound if available.

USB Charging Operation

REN features one 5 V / 1 A USB charging port on the back panel. This is a convenient power source for smart home devices or network streamers.

USB charging is available while REN is awake or in standby.

Connecting to a Computer

REN features a USB-C input for use with PCs and other audio equipment.

1. While the speakers are in standby or OFF, plug a USB cable into a USB port of the PC and the other into the USB input of REN. The following cable configurations will all work correctly with REN:

USB-C to USB-C

USB-C to USB-C w/ USB-A adapter

USB-C to USB-A

2. Turn ON or wake the speakers and select the USB input using the REN remote. You can also cycle through inputs by pressing the knob on the front of REN.

After your PC recognizes the speakers, it should automatically start outputting audio through the USB connection and you should hear audio from your PC being played through the speakers. If you do not hear any audio, you may have to manually change the PC's audio output to "REN by Kanto" in your PC's audio settings. If you still do not hear any audio after making these changes, refer to the Audio Troubleshooting Guide.

REN is capable of controlling your audio player (streaming service, music application, etc.) using the Play / Pause and Next Track / Previous Track buttons on the remote. Be aware that some audio players may not respond to these remote commands.

Connecting to a Turntable

REN requires a turntable with a built-in phono pre-amp or an external phono pre-amp. REN needs a line-level signal to achieve proper listening levels – it will be quiet if sent a phono signal.

1. While the speakers are in standby or OFF, plug your turntable's audio cables into the right and left RCA input of REN. If your turntable has a ground wire, connect it to your external pre-amp, or leave it unconnected if your turntable has an internal pre-amp.
2. Turn on or wake the speakers and select the RCA input using the REN remote. You can also cycle through inputs by pressing the control knob on the front of REN. After you adjust the volume on the speakers you should hear the audio from your turntable being played through the speakers. If you do not hear any audio, or the audio is quiet, please ensure your pre-amp is enable or refer to the Audio Troubleshooting Guide.

Connecting Bluetooth®

REN features Bluetooth® 5.3 with the AAC codec and can be paired with many devices for wireless audio playback from your phone or tablet. Pairing is easy.

1. Press the Bluetooth® button on REN's remote to select BT as the input source. You can also cycle through inputs by pressing the control knob on the front of REN. REN will attempt to reconnect to the last connected device but is also available for new devices to connect. You can also enter pairing mode manually by pressing the Bluetooth® Reset button (⌘) on the remote (see diagram of Remote Control on Pg. 6 – button #15).
2. Enable your Bluetooth® device to search for a new device to pair with. Select 'REN by Kanto' from the list of Bluetooth® devices available for pairing.
3. If pairing is successful, the LED will remain solid. You will not need to pair the same Bluetooth® device again – 'REN by Kanto' will remain on your device list until you remove it from the list.
4. If the device does not pair with REN, press the Bluetooth® Reset button (⌘) on the remote or turn off Bluetooth® on your device and turn it back on again, then repeat Steps 1 to 3. Alternatively, you can turn the speaker's Power Switch to the OFF position, then back to ON.

Bluetooth® Operation

1. We recommend keeping a maximum distance of less than 10 meters (33 ft) between the speaker and your device. The best signal fidelity is within this range.
2. You can stream audio from your device to the speaker using either the player control buttons of your device or the control buttons of the remote control (see diagram of Remote Control on Pg. 6 of this manual – buttons #18, #19, and #20).
3. Take note of the following behavior and functionality during Bluetooth® operation. When you are successfully connected, the LED will be lit solid, and your device will show as connected to 'REN by Kanto'.
4. The REN remote control features a Bluetooth® Reset button to quickly disconnect a paired device and allow a second device to pair with the speaker. Press Bluetooth® Reset button (⌘) to disconnect a paired device if necessary.
5. Follow the pairing instructions to pair another device.
6. The same behavior and functionality apply to the second device.

Connecting a Subwoofer

REN is equipped with an RCA connector to provide output signal to a powered subwoofer. Simply connect a single RCA subwoofer cable from the Subwoofer Out connection on REN to the RCA input on your subwoofer. If your subwoofer has a stereo L / R RCA input, either left or right inputs will work.

We recommend the Kanto sub6 or sub8 powered subwoofer with crossover and volume controls. Most quality subwoofers offer these controls, which allow you to customize the amount of bass you will experience.

Look for details on the Kanto website at: www.kantoaudio.com

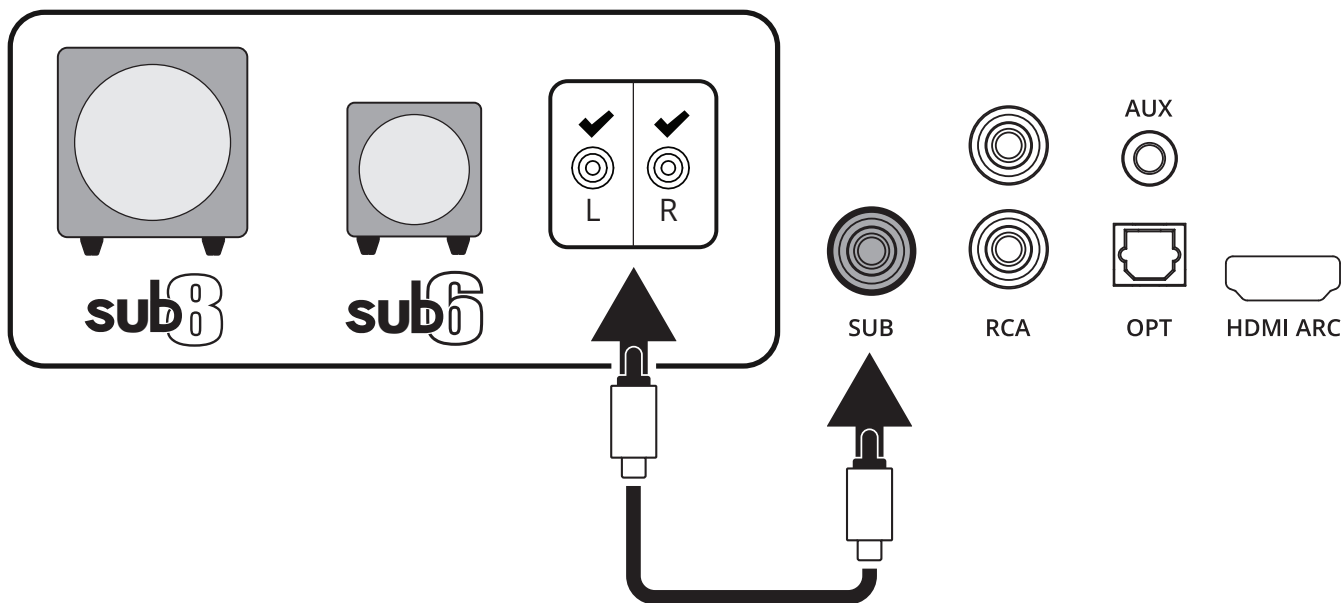

Sub Mute

You can mute the Subwoofer Output on REN. This can be helpful in situations where you want to listen to your speakers but don't want to disturb the neighbors with sub-bass.

To mute the sub output, press the Sub button. The LED will blink to confirm the subwoofer output is muted. To un-mute the subwoofer output, press the Sub button again. The LED will blink to confirm that the sub output has been un-muted. The Subwoofer Output will be reactivated upon waking up from standby.

Active Crossover

REN is equipped with an active crossover filter at 80 Hz to allow for advanced setup with subwoofers. The crossover will reduce the bass extension of the main speakers, allowing them to focus on the mid and high frequencies, while reducing the high frequency output of the Subwoofer Output. If your subwoofer has an adjustable bandwidth or crossover frequency setting, it can be adjusted to the highest or most open setting.

The Active Crossover will automatically activate when a subwoofer cable is connected to the Subwoofer Output (Labelled SUB). If the Sub Mute function is activated, the high-pass filter on the main output will become inactive. From any active configuration, if the Sub button is pressed and held for more than 5 seconds, the state of the high-pass filter will invert to accommodate edge cases.

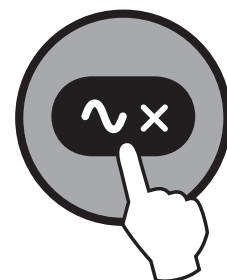

Special Functions

Sound Modes

REN offers two sound modes to solve some common issues faced when watching modern content.

Vocal Boost increases midrange frequencies found in the human voice to improve intelligibility when dialogue is quiet.

Night Mode applies a high-pass filter to the speakers and mutes any attached subwoofer to reduce low frequency content that could transmit to other areas of your home or through walls. A small amount of compression is also applied in this mode to gently reduce the volume of quick, loud sound effects.

Press the Sound Mode button once to enable Vocal Boost, and one more time to enable Night Mode. Pressing the button a third time will revert the speakers to normal, but you can quickly hold the Sound Mode button for 5 seconds to quickly revert back to normal without cycling through the Sound Modes.

Automatic Power Up (APU) / Automatic Power Down (APD)

REN is designed to save power when not in use. When no audio signal has been detected for 15 minutes, REN will automatically power down (APD) into standby. If the audio signal returns via the same input that REN was playing when it entered standby, REN will automatically power up (APU). It can also be woken up manually by:

- Pressing the Standby Button on the Remote
- Pressing the Control knob

If you do not find the APU feature useful, you can disable it by pressing the Treble Reset button on the remote and holding it for 5 seconds. The LED will blink once to indicate that you have disabled the APU feature. To enable APU if you have disabled it, simply press and hold the Treble Reset button again for 5 seconds. The LED will blink twice to indicate that you have enabled APU.

If you do not find the APD feature useful, you can disable it by pressing the Bass Reset button on the remote and holding it for 5 seconds. The LED will blink once to indicate that you have disabled the APD feature. To enable APD if you have disabled it, simply press and hold the Bass Reset button again for 5 seconds. The LED will blink twice to indicate that you have enabled APD.



Factory Reset

From active state, press and hold the control knob for 10 or more seconds. The front LED will blink twice, then the unit will go into standby with all factory settings restored.

LED Brightness

REN's LEDs on the front panel can be adjusted to 5 brightness levels including off. Cycle through the brightness settings by pressing the LED button on the REN remote.

Audio Troubleshooting Guide

Frequently asked questions about REN by Kanto.

1. The LED on the front panel is not illuminated.

- Make sure the power cable is connected to the speaker and power outlet.
- Ensure that the power outlet is providing power.
- Verify that the Power Switch on the rear of the speaker is in the ON position.
- Press the 'LED' IR button and see if it is set to off.

2. The LED on the front panel is illuminated but there's no audio playing.

- Make sure the correct input is selected. Press the knob on the front of the speakers or use the remote to select the different inputs to select the correct input.
- Set the volume of the source to its highest level. Ensure audio source is playing audio.
- Check that the audio cable connected to and from the source is firmly connected. Test another audio cable if available.
- Verify that the volume of the speaker is not at its minimum level. Turn the volume up using the knob on the front or the volume controls on the remote.

3. The remote is not functioning correctly.

- Ensure there is a clear line of sight from the remote to the speakers. Aim the remote at the IR Receiver.
- Check battery compartment of remote to make sure the batteries are installed and aligned correctly.
- Replace batteries.

4. Speakers are going into standby while listening to audio.

- Set the volume of the source to its highest level. Low source volume can inadvertently trigger standby mode.
- Disable Automatic Power Down (see Pg. 14).

5. You are experiencing poor audio quality.

- Set the volume of the source to its highest level. Low source volume can negatively affect dynamic range.
- Ensure that the rear of the speaker is spaced away from the wall by at least 8 inches, allowing the rear port function to be left unimpeded.
- Set the bass and treble levels to the default setting
- Test a different song or source to isolate the issue.

6. The source will not connect to Bluetooth®.

- Ensure the speakers are in Bluetooth® mode. Press the knob on the front of the speakers or use the remote to cycle through the different inputs to select Bluetooth®
- Make sure the LED on the front panel of REN is blue and blinking rapidly, indicating the speakers are in pairing mode. If the LED is solidly lit, press the Bluetooth® reset button on the remote to unpair a previously used device and enter pairing mode.
- On the source, turn Bluetooth® off and on again.
- If "REN by Kanto" cannot be found while searching for devices on the source, power-cycle the speaker by switching the Power Switch OFF then ON and try these steps again.

7. You are experiencing buzzing, hissing or distortion.

- If using the HDMI® ARC, USB or optical input, set the source's output to stereo — not surround, Dolby, DTS, or 5.1 — and set the sample rate to 96 kHz or lower.
- Verify if the noise is coming from the source by removing all sources from the speakers.
- Make sure it is not a power issue by trying a power outlet that is on a different circuit.
- Check that the audio cable connected to and from the source is firmly seated. Try a different cable or source to isolate the issue.

8. There's no audio coming from an attached subwoofer.

- Check if the subwoofer is muted by pressing the Sub button (see Sub Mute on Pg. 13 for more info).
- Check that the RCA cable connected to and from the subwoofer is firmly seated. Try a different cable or source to isolate the issue.
- Make sure the subwoofer is connected to a power outlet and is ON.
- Increase the volume of the subwoofer.
- Increase the cutoff frequency of the subwoofer.
- Reset to factory defaults by pressing and holding the control knob for 10 seconds.

NOTICE: The Bluetooth® word mark and logos are registered trademarks owned by Bluetooth SIG, Inc. and any use of such marks by Kanto Distribution Inc. is under license.

NOTICE: The terms HDMI®, HDMI High-Definition Multimedia Interface, HDMI Trade dress and the HDMI Logos are trademarks or registered trademarks of HDMI Licensing Administrator, Inc.



Limited Warranty

Kanto Living Inc. (Kanto) warrants the equipment it manufactures to be free from defects in material or workmanship for the limited warranty period of 2 years. This warranty is valid in the country of purchase.

If equipment fails and Kanto is notified within 24 months from the date of purchase with proof of original receipt from an authorized reseller, Kanto will, at its option, provide replacement parts, repair the original equipment, or replace the equipment, and be responsible for return shipping to the customer, provided that the equipment has not been subjected to mechanical, electrical, or other abuse or modifications. Any replacement parts repaired or replaced equipment are covered by the full warranty of the original purchase. The maximum liability of Kanto shall not exceed the actual purchase price paid by the original purchaser for the product.

If you purchased a Kanto product second-hand the limited warranty is fully transferable provided that you can furnish a copy of the original receipt to establish purchase date and the serial number on the product is intact.

Customers will be responsible for obtaining a Return Authorization Number through Customer Support and are responsible for return shipping costs to a Kanto location or authorized depot unless otherwise prohibited. Please keep the original packaging to prevent damage to the product during shipping. Kanto recommends insuring your shipment.

Customer Support: support@kantoliving.com

The information in the manual has been carefully checked and is believed to be accurate. However, Kanto assumes no responsibility for any inaccuracies that may be contained in the manual. In no event will Kanto be liable for direct, indirect, special, incidental, or consequential damages resulting from any defect in the equipment, even if advised of the possibility of such damages. This warranty is in lieu of all other warranties expressed or implied, including without limitation, any implied warranty, including any warranty of merchantability and fitness for any particular purpose, all of which are expressly disclaimed.