

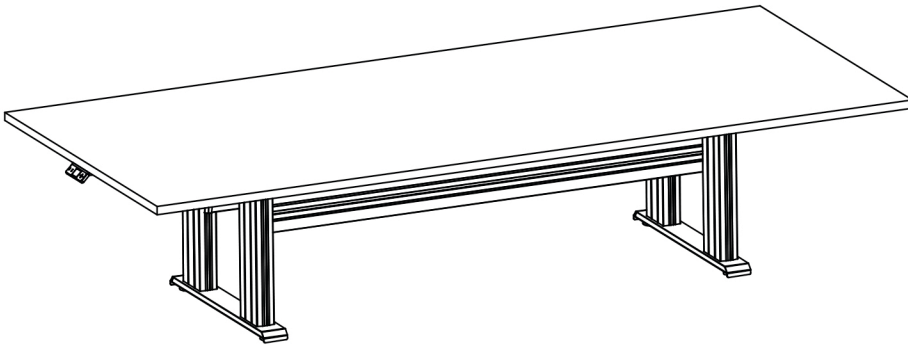

NewHeights™ Series 4 XT Elegante 4-Leg Conference Table

K&A Manufacturing
6703 Zinser Street
Schofield, WI 54476
Phone: 800.298.4351
Fax: 866.882.9475
www.raproducts.com
Version Dated: 5/8/18

Assembly/Operation Instructions



WARNING !

Do not attempt to raise the worksurface unless **BOTH** control boxes are plugged into a standard 110 volt power source and all wiring is complete as shown on page 7.



Failure to comply with or observe all assembly, safety, and operation instructions and warnings regarding the use of this product may result in serious property damage or bodily injury.

Make sure no obstacles are in the desk's path and all cords are of appropriate length for the desk. Always maintain a 1" clearance around the table to prevent pinching.

Never assemble (or disassemble) the table or components with the table plugged into a power outlet. This product is for use on a nominal 120-volt circuit and has a grounding plug. Make sure that the product is connected to an outlet having the same configuration as the plug. No adapter should be used with this product.

Duty Cycle: 2 minutes ON/18 minutes OFF

Workstation can continuously operate for a maximum duration of two minutes. After two minutes of non-stop operation, the workstation will automatically stop and require eighteen minutes of cool down.

Read all the instructions before beginning.



K&A Manufacturing
 6703 Zinser Street Schofield, WI 54476
 Phone: 800.298.4351
 Fax: 866.882.9475
 www.raproducts.com

Tools Required for Assembly:

Power Driver W/Adjustable Torque
 #2 Phillips Head Driver Bit or
 #2 Square Head Driver Bit
 3/16" Hex Head Driver Bit or
 Allen Wrench
 Tape Measure
 Level

**Hardware Pack # 53426
 is drawn actual size.**

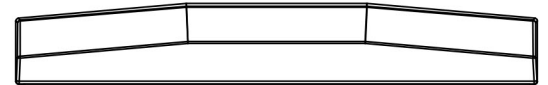
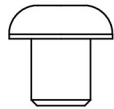
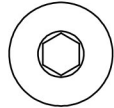

51708 (3)

53638 (7)

800943
 1/2 Size (8)

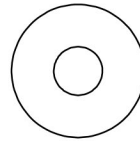

53174 (9)

53176 (11)

50072 (13)

ITEM #	PART #	DESCRIPTION	QTY.
1	Varies	Series 4 XT Conference Table Worksurface	1
2	801257	XT Conference 2 Column Leg Assembly	2
3	51708	M5 x 18mm (7/8") Sq/Ph/Wshr Head Wood Screw	52
4	Varies	XT Wire Management Channel	2
5	Varies	Series 4 Cross Support	2
6		Not Used	
7	53638	5/16 x 3/8 Button Head Socket Cap Screw	16
8	800934	Cross Support End Cap	4
9	53174	1/4-20x1/2 Phillips Pan Head Machine Screw	4
10		Not Used	
11	53176	.25x.696x.58 Flat Washer	4
12	50298	NewHeights Control Box	2
13	50072	8 x 3/4 Pan Head Recex Drive Screw	6
14	59169	Wire Management J	1
16	53729	4 Position Programable Switch	1
17	52604	3/16" Cable Clamp	4

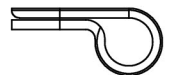
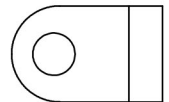

52604 (17)

Instruction # 53278

Step 1: Lay the worksurface **1** on a protected surface with the pilot holes facing up. Align the holes in the worksurface supports with the pilot holes in the worksurface. Be careful to not pinch the motor wires between the motor boxes and the worksurface. Do not allow the leg assemblies to stand without support. They could tip over and the motor housings could crack. The grommets on the motor wires should be in the square notches on the motor boxes. Attach the leg assemblies **2** to the worksurface with (24) wood screws **3**. Leave the screws loose by about 1/8" so you can adjust the leg assemblies when installing the wire management channels **4** and the cross supports **5**.

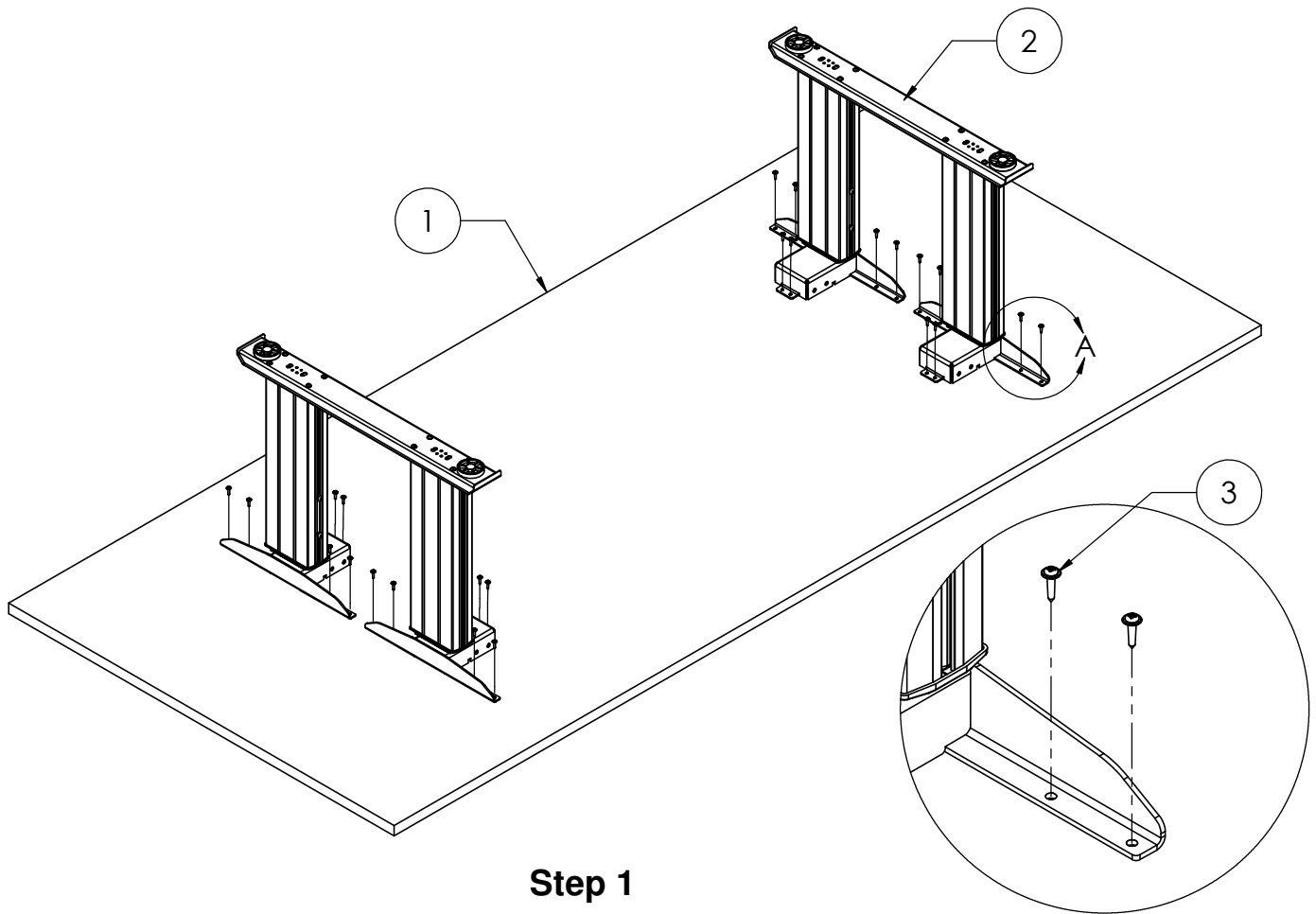

Step 1

Detail A

Step 2: Adjust one of the wire management channels **4** to align the holes in the channel with the holes on the inside of the motor boxes. Insert (4) socket screws **7** through the holes near the ends of the channel and thread them into the weld nuts on the motor boxes. See Detail B. Do not fully tighten. Attach the wire management channel to the worksurface with (5-10) wood screws **3**. Do not fully tighten. Repeat Step 2 with the remaining wire management channel.

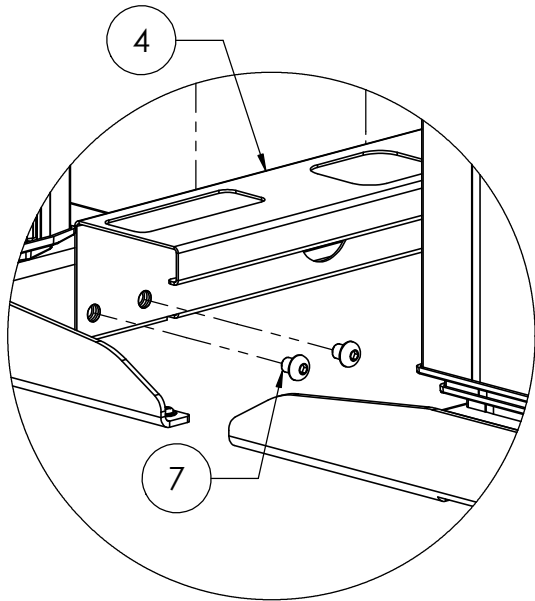

Detail B

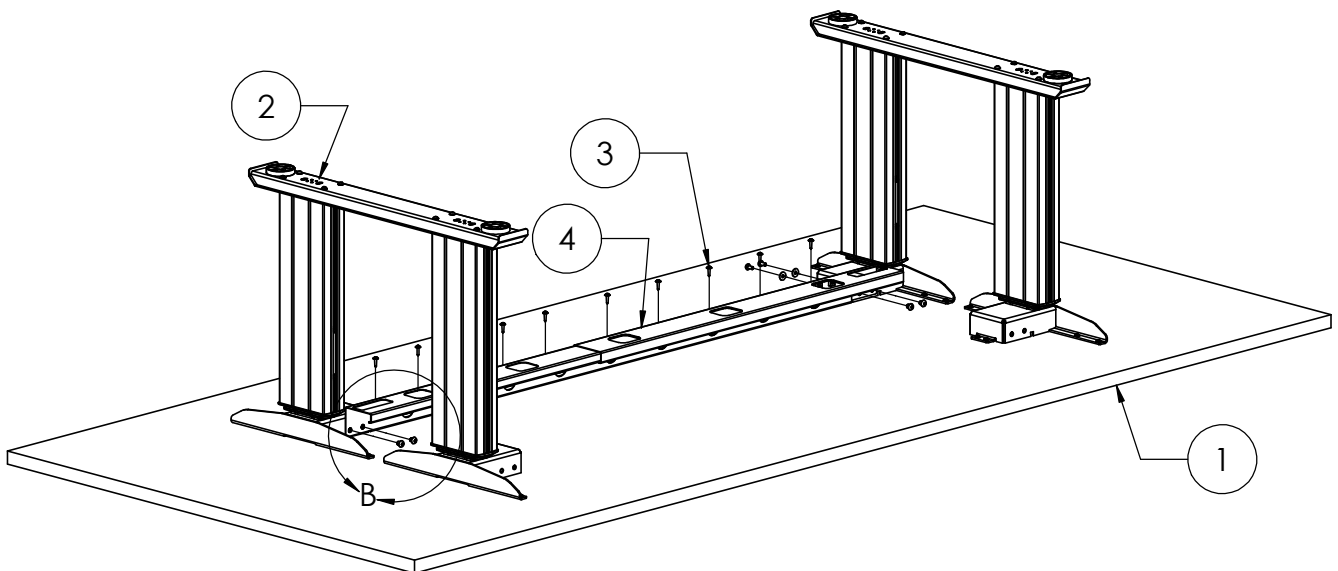

Step 2

Step 3: Place (2) flat washers **11** on (2) machine screws **9**. Thread these into the cage nuts pre-installed in the inner wire management channels and fully tighten. There are (4) cage nuts in each inner wire management channel. Use any (2) cage nuts that are accessible. See the back view below left.

Step 4: Fully tighten the socket screws **7** holding the wire management channels **4** to the motor boxes. Fully tighten the wood screws holding the wire management channels and the leg assemblies to the worksurface **1**. Do not over-tighten the screws. Use a low torque setting on the power driver.

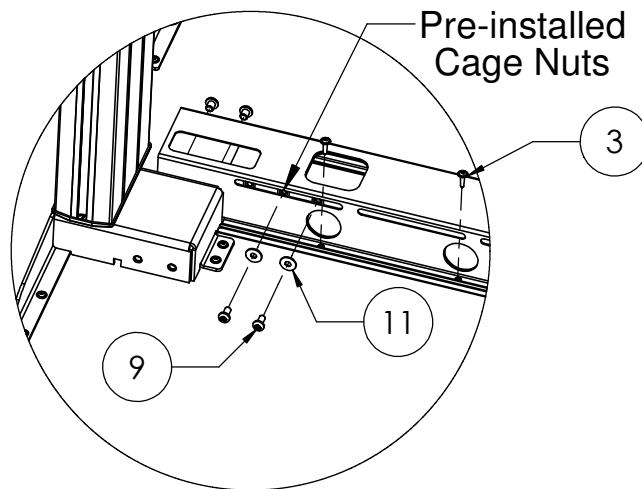

Back View

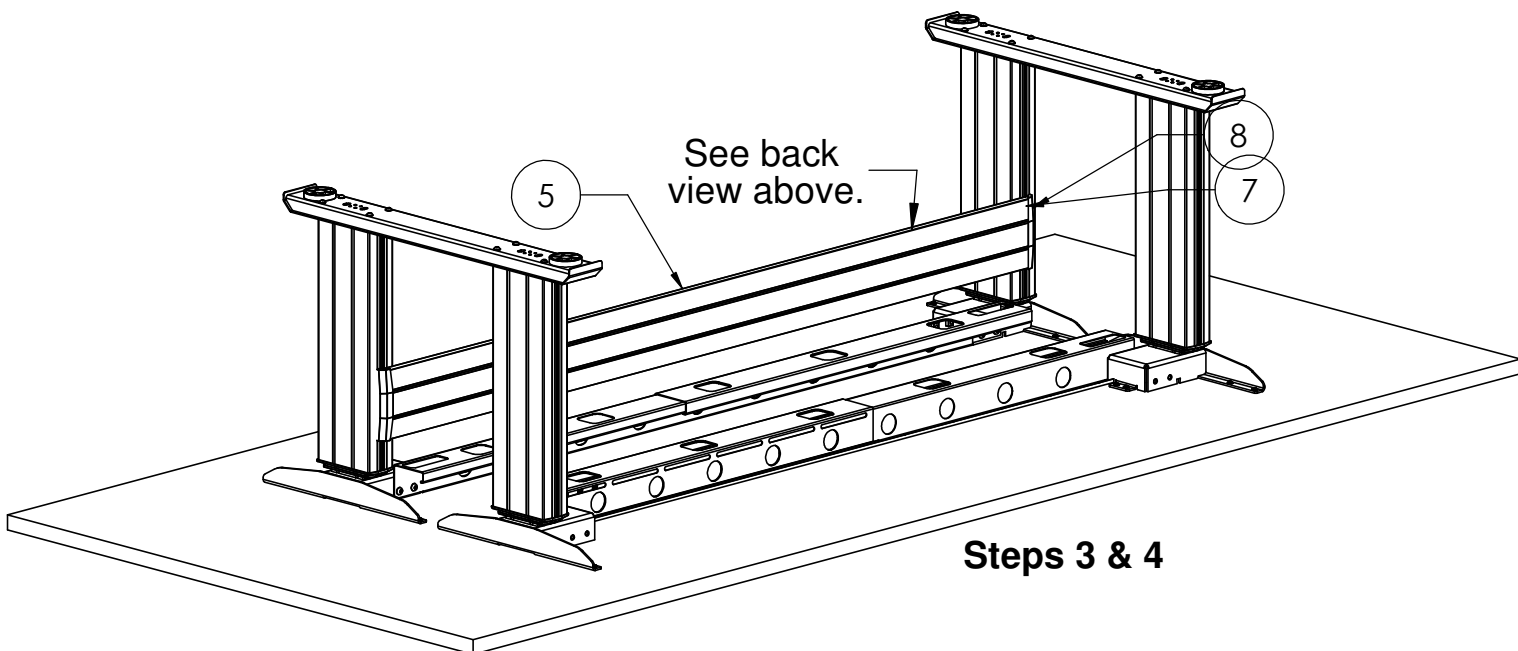

Steps 3 & 4



Step 5: With the help of an assistant align one of the cross support with the stickers on both leg assemblies. See below. Insert (4) socket screws **7** through the holes in the ends of the cross support **5** and thread them into the weld nuts that are held in place by the stickers. Do not fully tighten. Check that the cross support is level and parallel to the worksurface. Fully tighten the socket screws.

Step 6: Repeat step 5 with the other cross support

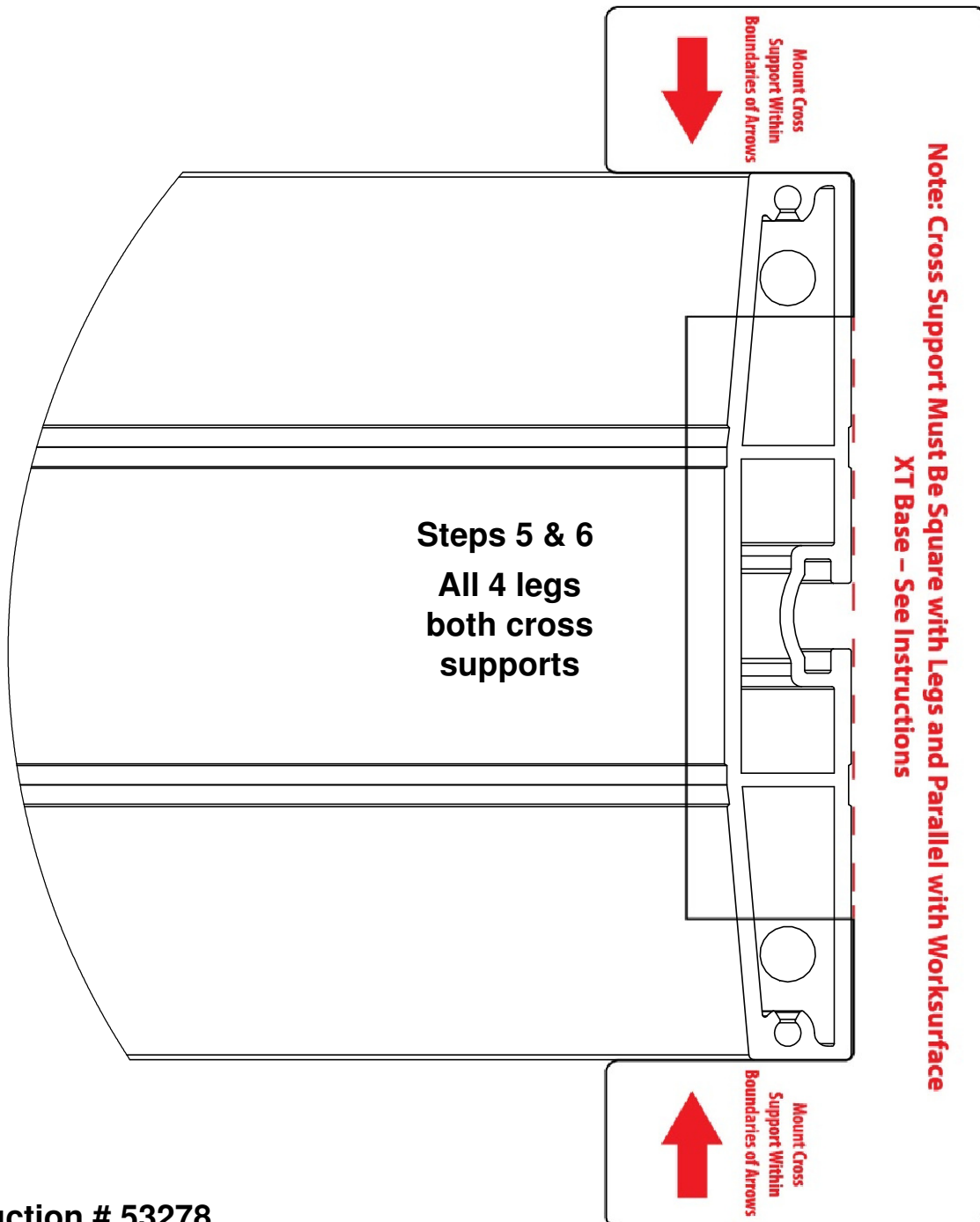



K&A Manufacturing
6703 Zinser Street Schofield, WI 54476
Phone: 800.298.4351
Fax: 866.882.9475
www.raproducts.com

Step 7: Align the holes in the control boxes **12** with the pilot holes in the worksurface **1**. Attach them with (2) wood screws **3** in each. Align the holes in the programmable switch **13** with the pilot holes in the worksurface. Refer to the instructions for the attachment and operation of the programmable switch. The control boxes and switch can be mounted at any location on the worksurface, wire lengths permitting.

Step 8: Attach the power strip **15** at the suggested location shown. It can be located anywhere. Attach it with the (4) screws that came with the power strip.

Step 9: Attach the wire management J **14** at the location shown using (1) wood screw **3**. No pilot hole is provided.

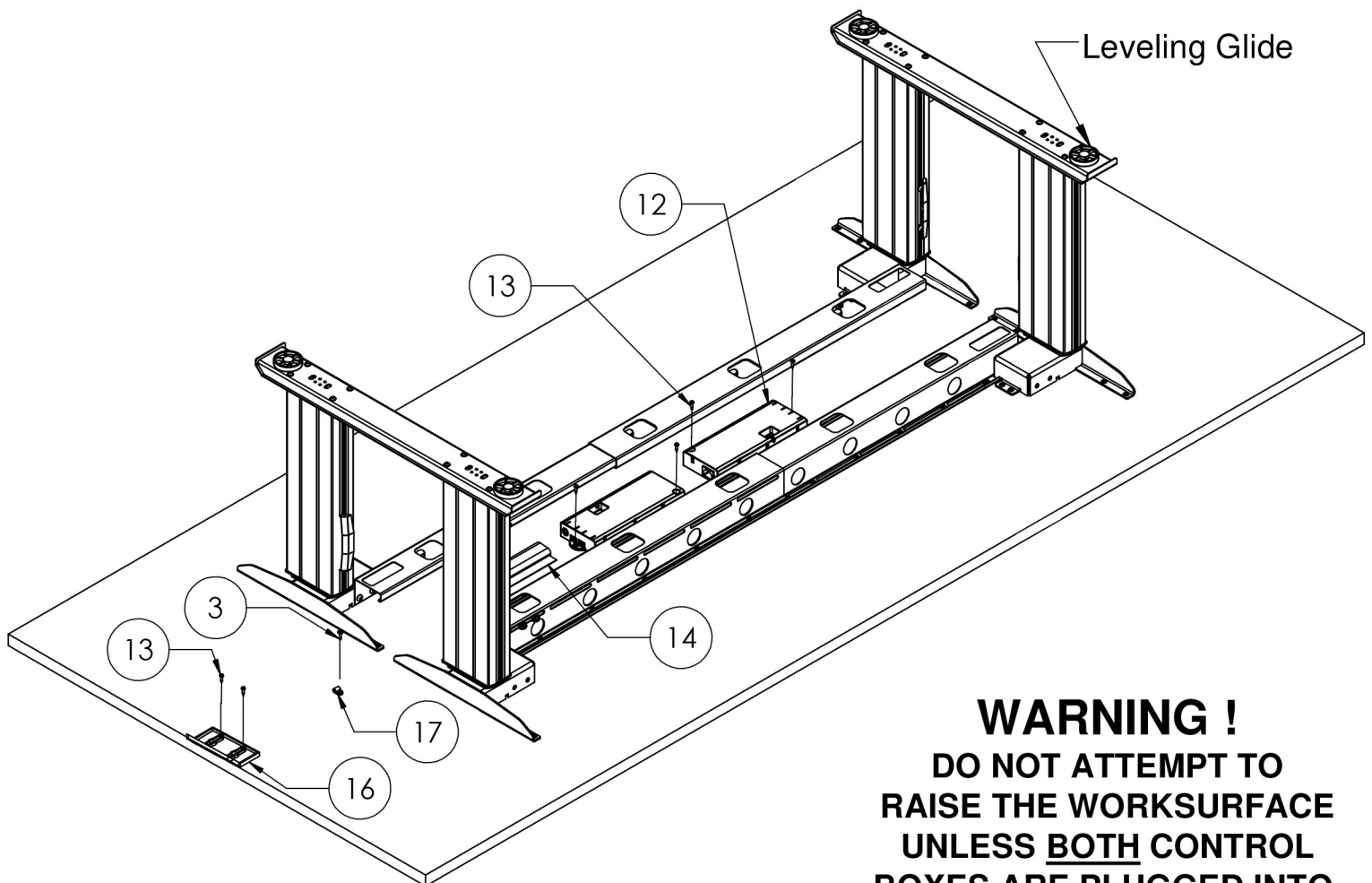

Steps 7-9

WARNING !
DO NOT ATTEMPT TO
RAISE THE WORKSURFACE
UNLESS BOTH CONTROL
BOXES ARE PLUGGED INTO
A STANDARD 110 VOLT
POWER SOURCE AND ALL
WIRING IS COMPLETE AS
SHOWN ON PAGE 6.

Step 10: Do not power up the control boxes until all the wiring is in place as shown below. Run the wires as shown in the schematic wire runs diagram below. Run the wires in the wire management channels. Capture the switch wire in the cable clamp **17** and attach it with (1) wood screw **3** at the location shown. No pilot hole is provided. Plug the wire from the programmable switch into the receptacle labeled HS in control box A. Plug the motor wires into the cables and plug the cables into the receptacles labeled M1 & M2 on both control boxes **12** as shown in the wiring diagram at left. Connect the control boxes together with the cascading cable plugged into the jacks on the top of the control boxes. Now the unit may be powered up.

Step 11: With the help of an assistant, set the table upright in its final location. Level the table if required by turning the leveling glides clockwise (from the top) on the low corners of the unit.

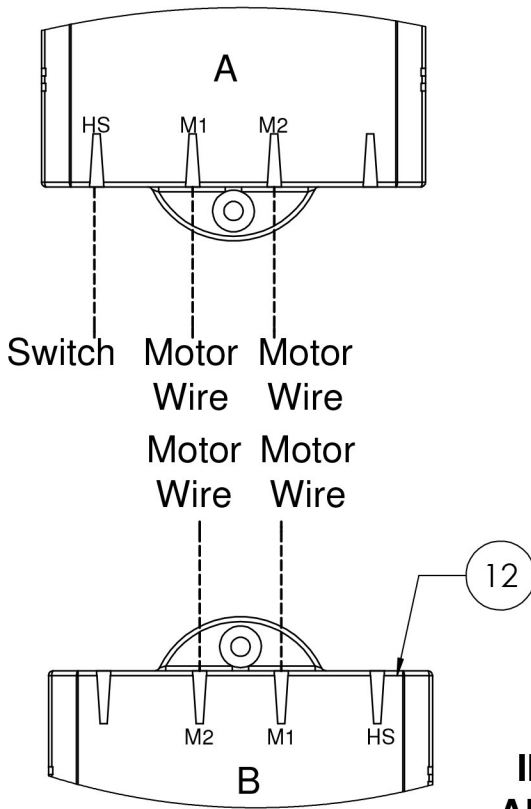

WARNING !
DO NOT ATTEMPT TO RAISE THE WORKSURFACE UNLESS BOTH CONTROL BOXES ARE PLUGGED INTO A STANDARD 110 VOLT POWER SOURCE AND ALL WIRING IS COMPLETE AS SHOWN ON THIS PAGE.

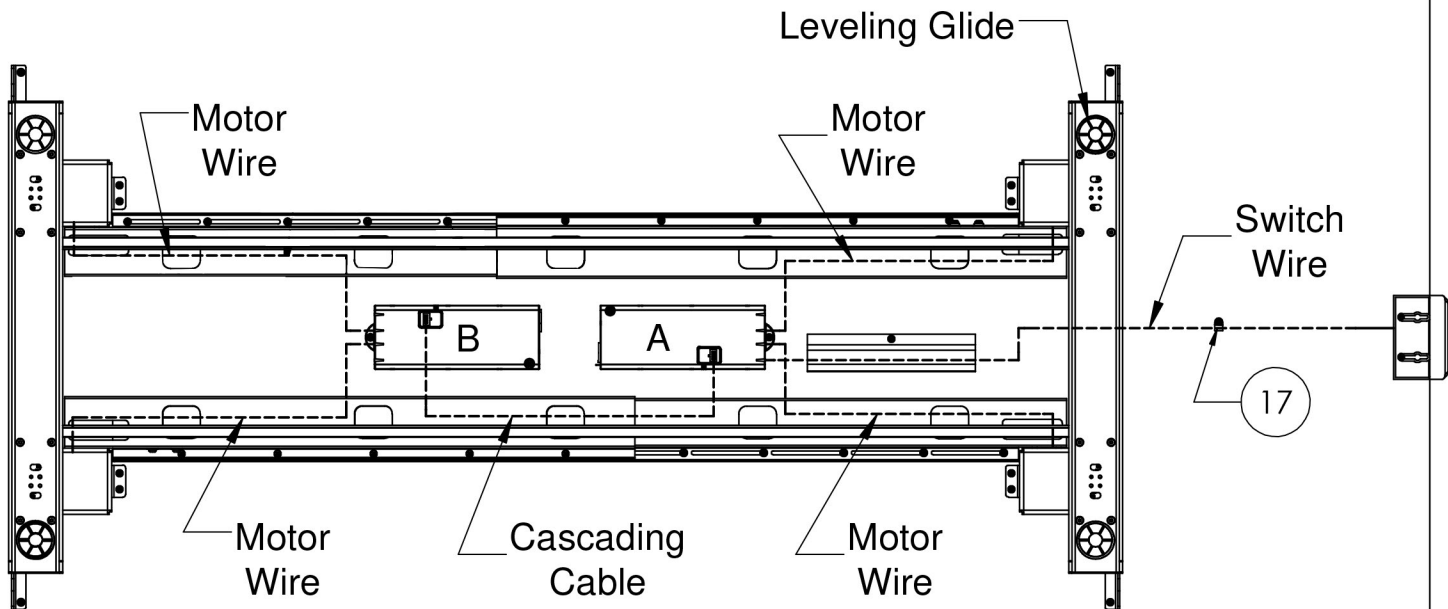

Steps 10 & 11



K&A Manufacturing
6703 Zinser Street Schofield, WI 54476
Phone: 800.298.4351
Fax: 866.882.9475
www.raproducts.com

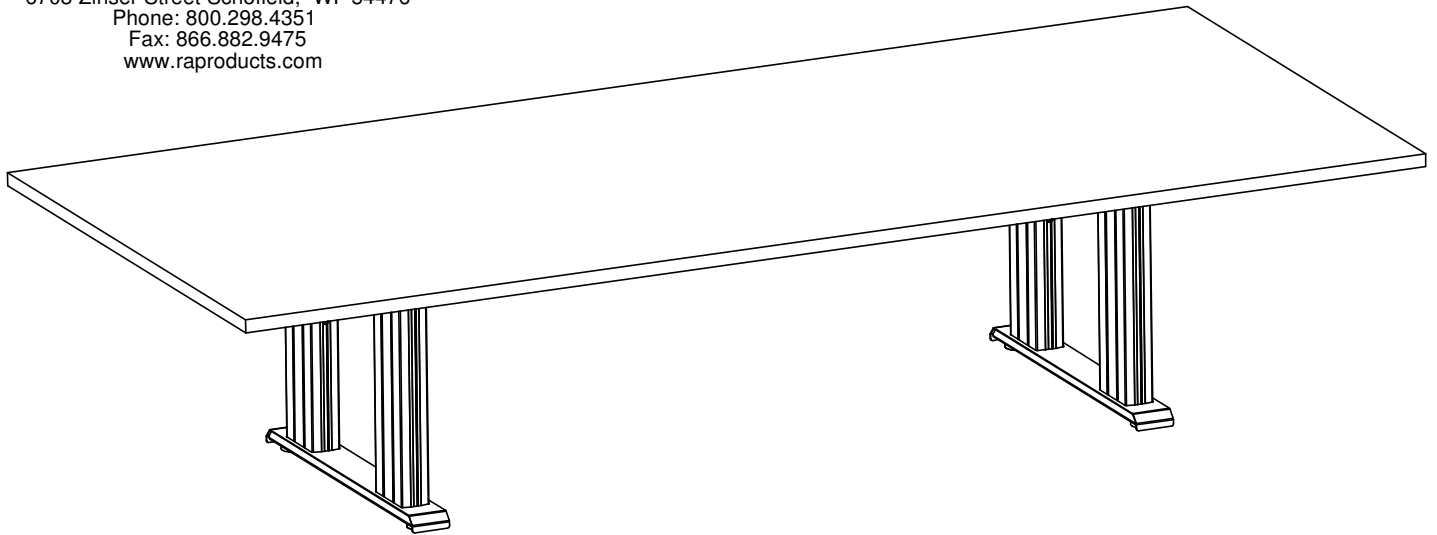

Operation and Reset Procedure

Plug both power cords into a standard 110v receptacle. A power surge protector is recommended. Press the down arrow button until the worksurface reaches its lowest position and clicks. The NewHeights™ workstation is ready for use. If you unplug or lose power and the unit does not operate, follow the reset procedure below

Reset Procedure: Unplug both power cords for 30 seconds and plug back in. Hold the down arrow button until the unit stops at the bottom. Release the button; then hold the down arrow button until the unit clicks twice.

Troubleshooting: If you are having any problems with the table operation, contact RightAngle™ at 800-298-4351 or orders@raproducts.com.

Warranty Information: NewHeights™ products are warranted to be free of defects due to manufacturing or materials as follows: Three years on the gear and/or motor(sw) including the control boxes and hand switch. Five years on the support brackets, aluminum columns and feet. We will replace any defective part after inspection by an authorized agent. Costs incurred due to product replacement such as installation labor or transportation are not covered under this warranty. When corresponding with RightAngle™ products, record and provide the model and serial numbers located on the control box.