

DETAIL B
SCALE 4 : 1

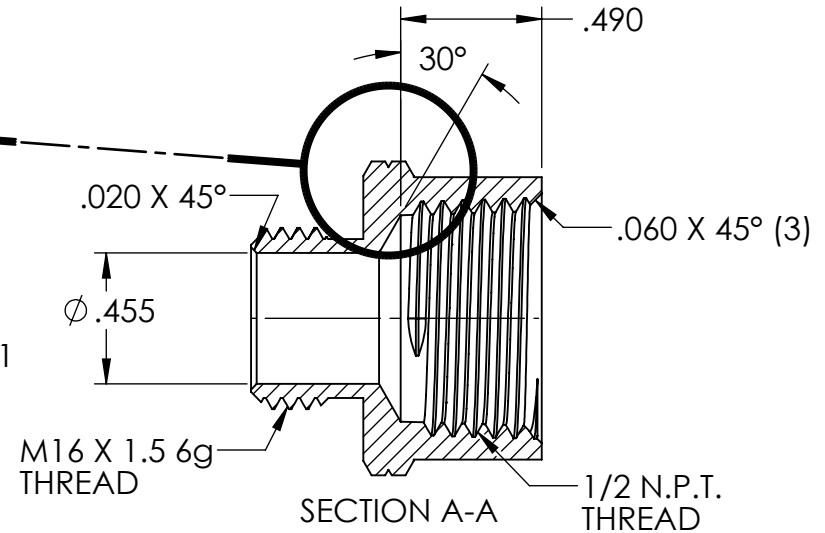
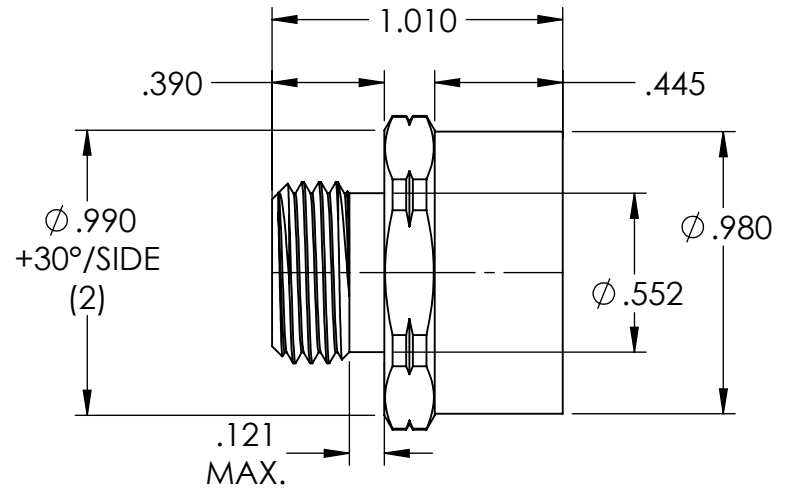

- NOTES:
 1.) PART A IS PLATED ELECTROLESS NICKEL .0001 MIN-.0003 MAX.
 2.) PART UP IS UNPLATED
 3.) BREAK ALL SHARP CORNERS
 4.) REF. BAR-17 (1" HEX X ALUMINUM)

REV.	DATE	CHANGE	UNLESS OTHERWISE SPECIFIED:	NAME	DATE	REMKE REMKE INDUSTRIES 310 CHADDICK DR, WHEELING, IL. 60090	
A	4/2/03	DRAWING RELEASED C.V.	DIMENSIONS ARE IN INCHES	DRAWN	JCN 7/15	TITLE:	
B	7/21/15	REDRAWN	TOLERANCES:	CHECKED		ADAPTER	
			FRACTIONAL ± 1/64	ENG APPR.		SIZE	DWG. NO.
			ANGULAR: MACH ± 1° BEND ± 1°	MFG APPR.		A	RAM-16M50F-A
			ONE PLACE DECIMAL ± .015	Q.A.		SCALE: 1.5:1	SHEET 1 OF 1
			TWO PLACE DECIMAL ± .010	PROPRIETARY AND CONFIDENTIAL THE INFORMATION CONTAINED IN THIS DRAWING IS THE SOLE PROPERTY OF REMKE INDUSTRIES. ANY REPRODUCTION IN PART OR AS A WHOLE WITHOUT THE WRITTEN PERMISSION OF REMKE INDUSTRIES IS PROHIBITED.			
			THREE PLACE DECIMAL ± .005				
			INTERPRET GEOMETRIC TOLERANCING PER:				
			MATERIAL				
			ALUMINUM				
			FINISH				
			NICKEL PLATED				
			DO NOT SCALE DRAWING				

5

4

3

2

1