

REMOVABLE CAP
FOR DUAL ENTRY
(INSERT IN OTHER SIDE)

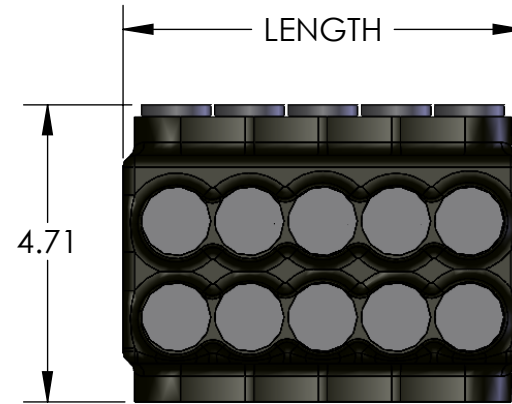

REMOVABLE CAP
TO TIGHTEN SCREW
(REPLACE WHEN COMPLETE)

5/16 INTERNAL
HEX PRESSURE SCREW

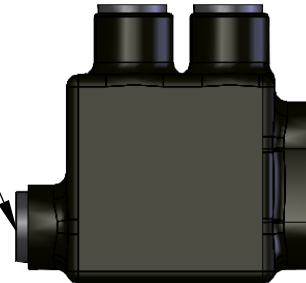

WIRE ENTRY PORT
WIRE RANGE: 500MCM - #4 AWG
PRE-FILLED W/ OXIDE INHIBITOR



IPLDS500-10 SHOWN

NSI PART NUMBER	UL PART NUMBER	NO. OF PORTS	LENGTH
IPLDS500-6	IS6F	6	4.01
IPLDS500-8	IS8F	8	5.16
IPLDS500-10	IS10F	10	6.30
IPLDS500-12	IS12F	12	7.45
IPLDS500-14	IS14F	14	8.59
IPLDS500-16	IS16F	16	9.74

NOTES:

- CONNECTOR MANUFACTURED FROM 6061-T6 ALUMINUM ALLOY.
- UL LISTED PER UL486A/B SPECIFICATIONS FOR 600V.
- DUAL RATED FOR 90°C COPPER AND/OR ALUMINUM CONDUCTOR.
- COLD TEMPERATURE RATED TO -45°C.
- HIGH DIELECTRIC STRENGTH INSULATION IS ABRASION AND CHEMICAL RESISTANT
- UV RATED

		POLARIS SALES . CO . INC	
PROPRIETARY AND CONFIDENTIAL		11625 PROSPEROUS DRIVE ODESSA, FL 33556	
THE INFORMATION CONTAINED IN THIS DRAWING IS THE SOLE PROPERTY OF POLARIS SALES CO. INC. ANY REPRODUCTION IN PART OR AS A WHOLE WITHOUT THE WRITTEN PERMISSION OF POLARIS SALES CO. INC. IS PROHIBITED.		TITLE: INSULATED STACKED DUAL ENTRY (BOTTOM ROW) 500 CONNECTOR	
DRAWN BY	L. HILL	REVISED	6/18/2024
MATERIAL: N/A		DWG. NO.	IPLDS500-
		SCALE: N/A	SHEET: 1 OF 1