

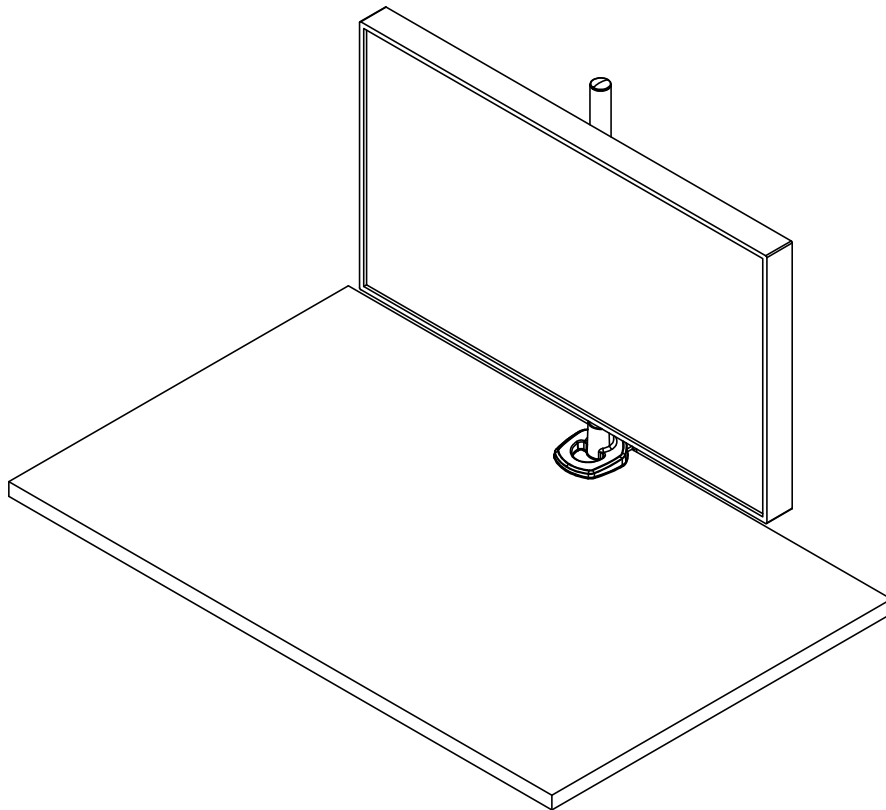

www.raproducts.com

HSTVMT Monitor/TV Hover Mount Assembly Instructions



Tools Required for Assembly:

Power Driver W/Adjustable Torque
5/32" Hex Head Driver Bit or
Allen Wrench
10mm Wrench or Socket

Parts

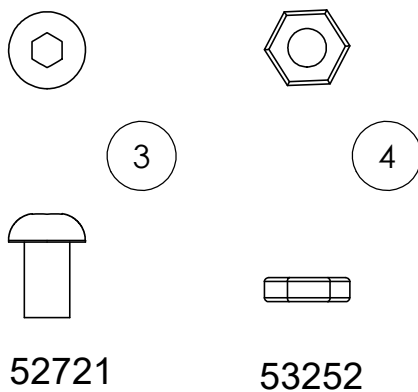

ITEM #	PART #	DESCRIPTION	QTY.
1	801507	Monitor/TV Hover Mounting Plate	1
2	801508	Monitor/TV Hover Side Wing	2
3	52721	M6-1.0x8mm Truss Head Machine Screw	8
4	53252	M6-1 Hex Jam Nut 3mm Thick	4
5	801510	Monitor/TV Hover Mount Pole Joint	1
6	52743	Hover 27.6" Pole	1

The hardware kit also includes screws, washers, and spacers to help attach the tv to the monitor mount.
The sizes included fit most TV monitors. However, please consult your TVs user manual for complete information about the correct screw sizes for your particular monitor.

It is the customer's responsibility to use the correct screw length. Use proper screws and washers (spaces if needed) according to the product guide provided by the TV / monitor manufacturer. Using the wrong size can result in damage of the monitor.

What's included: M4 x 12 mm Screws = 4 pieces, M5 x 12 mm Screws = 4 pieces, M6 x 12 mm Screws = 4 pieces, M6 x 35 mm Screws = 4 pieces, M8 x 16 mm Screws = 4 pieces, M8 x 25 mm Screws = 4 pieces, M8 x 30 mm Screws = 4 pieces, M8 x 45 mm Screws = 4 pieces, M8 x 50 mm Screws = 4 pieces, M4/M5 Washers = 8 pieces, M6/M8 Washers = 8 pieces, 2.0 mm M6/M8 Spacers = 8 pieces, 20.5 mm M6/M8 Spacers = 4 pieces, 12.5 mm M4/M5 Spacers = 4 pieces, Bubble-level = 1 piece, Total = 69 pieces

Step 1a: If you are mounting a small TV or monitor with 100mm or 200mm distance between the mounting holes, use Step 1a. This setup will not use the side wings 2 . Attach the pole joint 5 to the raised side of the mounting plate 1 using (4) machine screws 3 . Fully tighten.

Step 1b: If you are mounting a large TV or monitor with greater than 200mm distance between the mounting holes, use Step 1b. This setup will use the side wings 2 . Attach the pole joint 5 to the recessed side of the mounting plate 1 using (4) machine screws 3 . Fully tighten

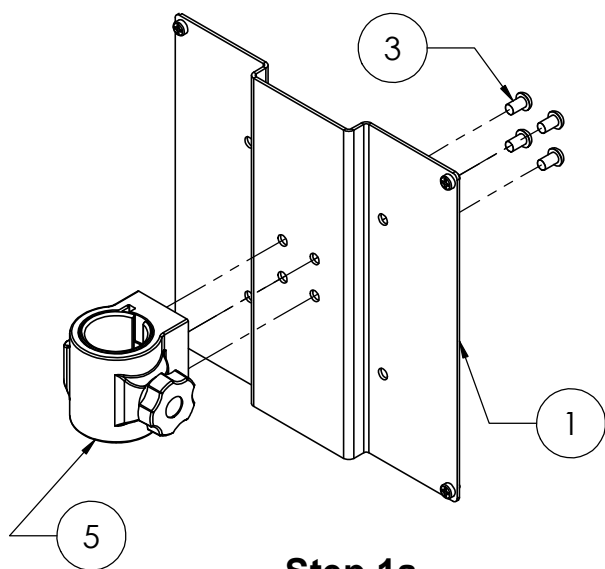

Step 1a

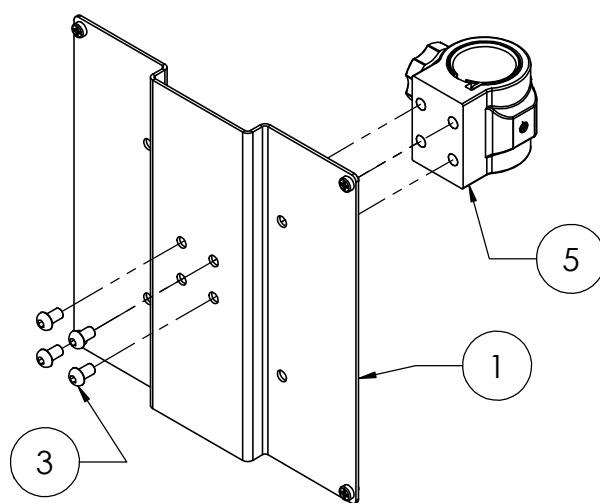

Step 1b

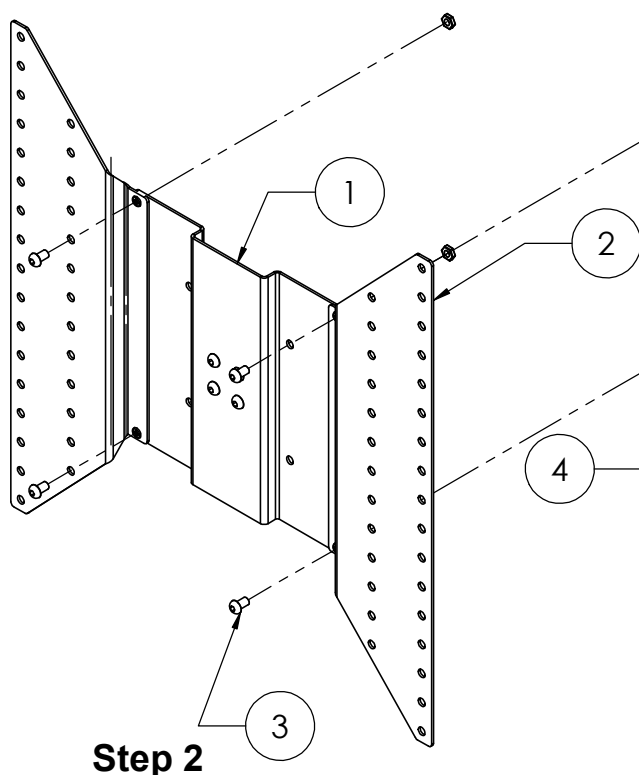

Step 2

Step 2: Do this step only if you have a large TV or monitor with greater than 200mm between the mounting holes. Insert (4) machine screws 3 through the holes in the narrow flange of the side wings 2 and the outermost holes in the mounting plate 1. Thread (4) nuts 4 onto the screws and fully tighten.

Step 3a: Place your monitor on a protected surface face down. Attach the mounting plate assembly to your monitor or small TV using (4) machine screws

through the inner holes that are 100mm apart in the mounting plate 1. Fully tighten.

Step 3b: Place your TV or large monitor on a protected surface face down. Attach the side wings 2 to the back of your TV or large monitor using either the holes that are 200mm or 400mm apart. Use (4) machine screws

. Fully

tighten.

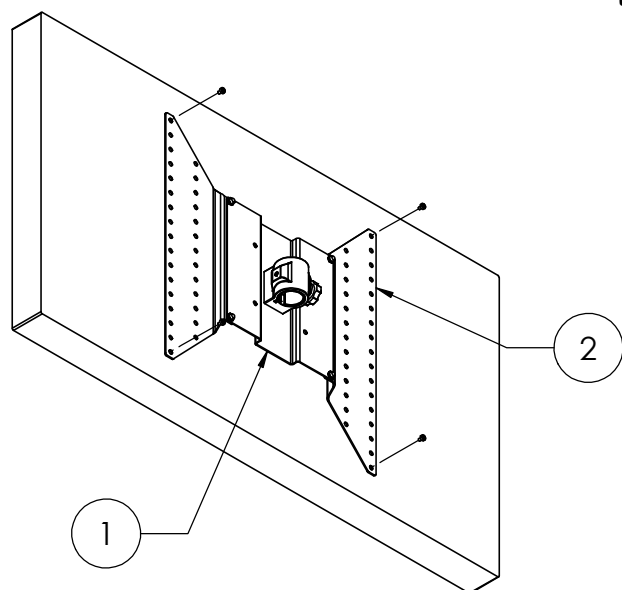

Step 3b

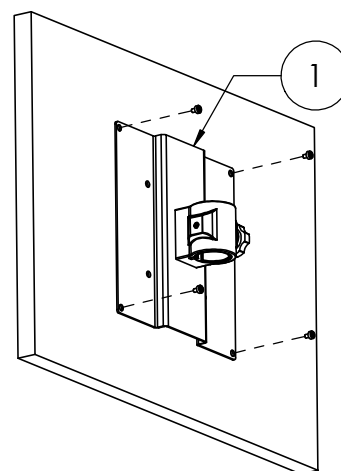

Step 3a

**It is the customer's responsibility to use the correct screw length. Use proper screws and washers (spaces if needed) according to the product guide provided by the TV / monitor manufacturer.*

Step 4: Attach the pole 6 to the worksurface using the instructions that came with it.

Step 5: With the help of an assistant, place the mounting assembly's pole joint 5 onto the pole 6. Set it at the height desired and tighten the clamp on the pole joint. This step is the same whether or not the side wings 2 are used.

