

BODY

1-1/4 N.P.T.  
INTERNAL THREAD

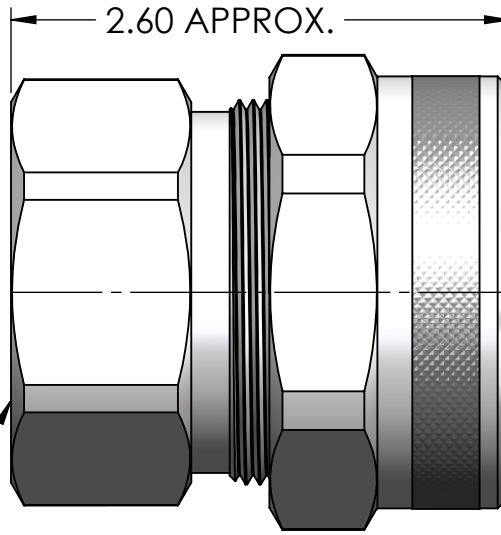

2.60 APPROX.

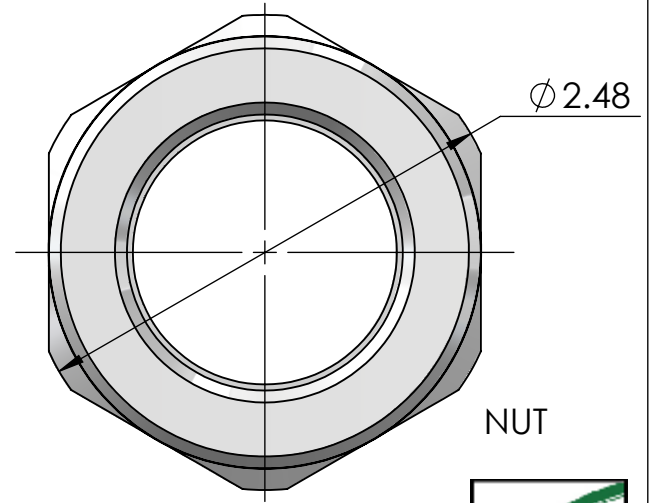

NUT



ITEM NO.	PART NUMBER	DESCRIPTION	MATERIAL	QTY.
1	RSRF-400-B	BODY	ALUMINUM	1
2	SRB-411 - 422	BUSHING	NEOPRENE	1
3	RSR-500-N	NUT	ALUMINUM	1
4	SW-500	WASHER	C.R.S. ZINC PLATED	1

PART NUMBER	SEALING RANGE	BODY BORE
RSRF-411	.562 - .688	1.375
RSRF-413	.688 - .812	1.375
RSRF-414	.750 - .875	1.375
RSRF-416	.875 - 1.000	1.375
RSRF-418	1.000 - 1.125	1.375
RSRF-420	1.125 - 1.250	1.375
RSRF-422	1.250 - 1.375	1.375

REV.	DATE	CHANGE	UNLESS OTHERWISE SPECIFIED:	NAME	DATE	 <b>REMKE INDUSTRIES</b> 310 CHADDICK DR, WHEELING, IL. 60090	
A	7/1/15	DRAWING RELEASED	DIMENSIONS ARE IN INCHES TOLERANCES: FRACTIONAL ± 1/64 ANGULAR: MACH ± 1° BEND ± 1° ONE PLACE DECIMAL ± .015 TWO PLACE DECIMAL ± .010 THREE PLACE DECIMAL ± .005 INTERPRET GEOMETRIC TOLERANCING PER: MATERIAL FINISH DO NOT SCALE DRAWING	DRAWN CHECKED ENG APPR. MFG APPR. Q.A.	JCN 7/15	TITLE: <b>RSRF-400-SERIES</b>	
			<b>PROPRIETARY AND CONFIDENTIAL</b> THE INFORMATION CONTAINED IN THIS DRAWING IS THE SOLE PROPERTY OF REMKE INDUSTRIES. ANY REPRODUCTION IN PART OR AS A WHOLE WITHOUT THE WRITTEN PERMISSION OF REMKE INDUSTRIES IS PROHIBITED.			SIZE <b>A</b>	DWG. NO. <b>RSRF-400- ASSEMBLY</b>
			SCALE: 1:1		SHEET 1 OF 1		

5

4

3

2

1