

TORK[®] nsi INDUSTRIES

SPECIFICATION SHEET

Project Info:	Type:
Job Ref:	Catalog Number:
Approvals:	Date:

ZTL480

Advanced Electronic LED Photocontrol



OVERVIEW

The ZTL Series Photocontrol is designed with enhanced ZERO-CROSS Switching Technology allowing it to withstand the high inrush currents commonly found in LED Luminaires.

APPLICATIONS & FEATURES

- All LED, CFL, Induction, HPS and HID lighting fixtures requiring dusk to dawn control and enhanced protection against extreme inrush currents.
- Ideal for roadway, area, parking, flood and security type lighting fixtures where FAIL ON is required.
- Enhanced 510 Joule MOV surge device providing superior surge protection against unpredictable line voltage spikes.
- Superior light sensing technology driven by a Non-Drifting Filtered Silicon Sensor designed for extreme accuracy and Human Eye Response.
- Circuit Board protection enhanced with conformal coating to protect against extreme weather elements and moisture.
- Photocontrol designed for 20 year long life requirement found on most LED fixtures.

SPECIFICATIONS

- **Voltage:** 347-480VAC, 50/60Hz.
- **Ballast:** 1800VA.
- **LED Electronic Ballast:** 3A or Totaling 1000W@347-480VAC.
- **Dielectric Strength:** 2500VAC.
- **Turn ON Light Level:** 1.5 fc +/- 0.2 fc Instant ON.
- **Turn OFF Light Level:** 1.5:1 (2.25 fc) with 3 second delay.
- **Operating Temperature:** -40°F to 158°F (-40°C to 70°C).
- **Fail Mode:** ON
- **Surge Protection:** 510 Joule MOV.
- **Power Consumption:** <.5 Watts.
- **UL Tested:** 15,000 Cycles.

ZTL480
Zero-Cross Electronic LED Photocontrol Mounting Turn-Lock

DIMENSIONS

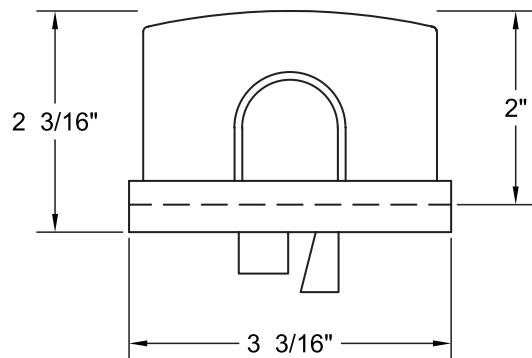

REGULATORY LISTINGS

- ANSI C136.10-2010
- UL773 & CSA TIL A15



LIMITED WARRANTY

- 15-year manufacture's warranty