

REV	DATE	REVISED	BY	ECN	C'R'D
A		RELEASED			
B	7/31/23	UPDATED ITEM SPECIFICATION	DC	23-00015	SSM
C	6/4/24	VALOW WAS VAALOX	DC	24-00074	SSM

FUSE TABLE	
Overcurrent Protection, Fuse Required Class	Maximum Amp Rating
Class J	110A
Class T	110A
Class RK1	60A
Class RK5	30A
Class G	60A
Class CC	30A

**FEATURES:**

- 1. AVAILABLE IN FINGER SAFE STYLE MODEL ONLY THAT INCLUDE END PLATES AND HINGED COVER
- 2. FINGER SAFE TO IP20. PER. IEC60529
- 3. cULus LISTED TO UL 1953 AND 1059
- 4. AL9CU RATED FOR USE T=WITH COPPER OR ALUMINUM CONDUCTOR CLASS B & C, AND OPERTAING TEMP OF 90C
- 5. VOLTAGE RATING 600 V
- 6. DEFAULT SCCR (SHORT CIRCUIT CURRENT RATING) WITH CORRECT FUSING = 100kA
- 7. QUICK RELEASE LOCKING MECHANISM TO DISCONNECT FROM STD.35MM DIN RAIL
- 8. OVAL ALIGN MOUNTING HOLE AT BASE ON EITHER WIRE ENTRY END
- 9. MATERIAL: COVER AND END PLATES = LEXAN 500R POLYCARBONATE
- 10. MATERIAL: BASE AND SIDE PANELS = VALOX NYLON 6/6 GF30%
- 11. MATERIAL: CONNECTOR BLOCK 6061T6 ALUMINUM TIN PLATED
- 12. MATERIAL: WIRE PORT SCREWS, STEEL TIN PLATED
- 13. MATERIAL: CONNECTOR TO BLOCK SECURITY SCREW, STEEL TIN PLATED
- 14. MULTI-PORT GANGING OF SAME SIZE BLOCK (SML, MED, LRG)
- 15. MAXIMUM AMPACITY PER POLE = 475A
- 16. PRIMARY (LINE, RUN, MAIN ) SIDE = 750 MCM
- 17. PRIMARY MAXIMUM TORQUE VALUE = 442 IN.LBF
- 18. PRIMARY STRIP LENGTH = 1.732"
- 19. MAXIMUM AMPACITY PER POLE = 475A
- 20. SECONDARY (LINE, RUN, MAIN ) SIDE = 750 MCM
- 21. SECONDARY MAXIMUM TORQUE VALUE = 442 IN.LBF
- 22. SECONDARY STRIP LENGTH = 1.732"

- NOTES:
- DIMENSIONS IN BRACKETS [ ] ARE IN MM ROUNDED OFF TO THE NEAREST MM, UNLESS OTHERWISE SPECIFIED AND ARE FOR REFERENCE ONLY
  - MATERIALS: BASE, POLE SEPERATING SIDE AND LOCK - NYLON 66 GF30%  
BLOCK AND RETENTION SCREWS - TIN PLATED ALUMINUM  
FINGER SAFE COVERS - POLYCARBONATE  
BLOCK MOUNTING HARDWARE - STAINLESS STEEL
  - MAY BE USED IN ANY NUMBER OF POLES REQUIRED.

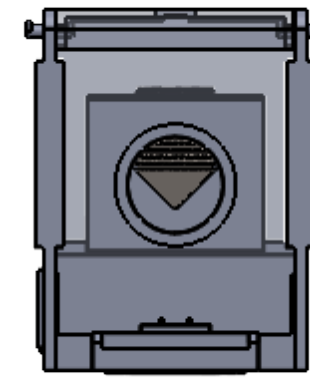
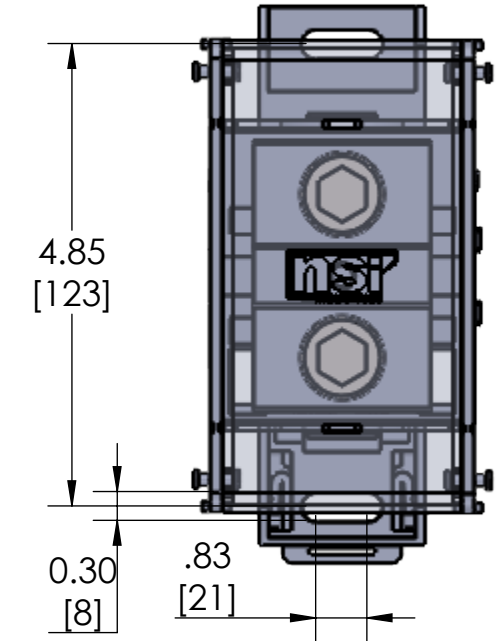
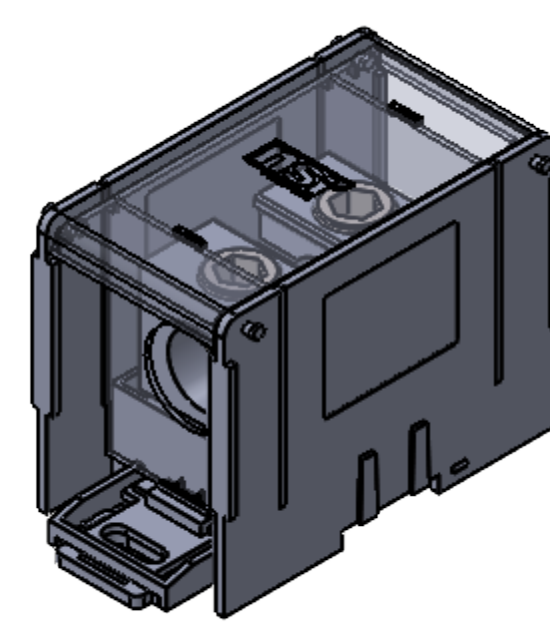

**RUN SIDE**

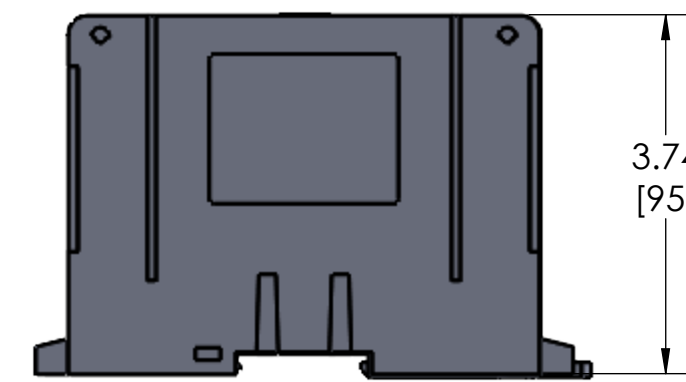

**DIN RAIL STYLE**

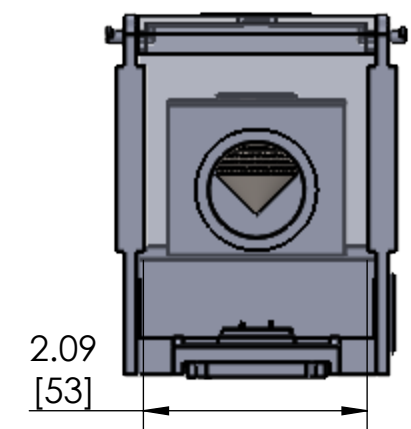

**TAP SIDE**

**2: TORQUE VALUES**

WIRE RANGE (MCM/AWG)	CONNECTOR SIZE									
	750	600	500	350	250	3/0	2/0	1/0	#2	#4
750 - 600	550	550								
500	550	450	450							
400	550	450	450							
350	550	400	400	400						
250	550	360	360	360	360					
4/0 - 3/0	550	250	250	250	250	250				
2/0	550	180	180	180	180	180	120			
1/0	550	180	180	180	180	180	80	80		
#1		150	150	150	150	150	65	65		
#2 - #3		150	150	150	150	150	65	65	65	
#4 - #6		150	110	110	110	110	55	55	35	35
#8				75			45	45	25	25
#10 - #14				35			25	25	15	15

NPDB -	11 -	750 -	1
NSI PRODUCT GROUP POWER DISTRIBUTION BLOCKS	1ST DIGIT = # OF PRIMARY COND. 2ND DIGIT = # OF SECONDARY COND.	MAXIMUM WIRE SIZE	NUMBER OF POLES

<b>PROPRIETARY AND CONFIDENTIAL</b>		NAME	DATE		
<small>THE INFORMATION CONTAINED IN THIS DRAWING IS THE SOLE PROPERTY OF NSI INDUSTRIES. ANY REPRODUCTION IN PART OR AS A WHOLE WITHOUT THE WRITTEN PERMISSION OF NSI INDUSTRIES IS PROHIBITED.</small> <small>DIM. UNLESS OTHERWISE NOTED ARE IN INCHES.            DECIMAL .001 &amp; .015            FRACTION 1/64            ANGLES DO NOT SCALE DRAWINGS 1" = 1"</small>		DRAWN	DC		7/31/23
		CHECKED	SSM		7/31/23
		ENG APPR.			
		MFG APPR.			
MATERIAL		Q.A.		TITLE: POWER DISTRIBUTION BLOCKS	
FINISH		COMMENTS: TO ORDER NSI PRODUCTS CALL UNITED STATES (704) 439-2420 FOR PRODUCT INFO: www.nsiindustries.com		SIZE DWG. NO. MODEL. NO. REV <b>C</b> NPDB-11-750-1 <b>C</b>	
DIMENSIONS ARE IN INCHES		SCALE:1:2		SOLIDWORKS 2022 SHEET 1 OF 1	