

HOW TO INSTALL SLIME SELF-SEALING TUBES

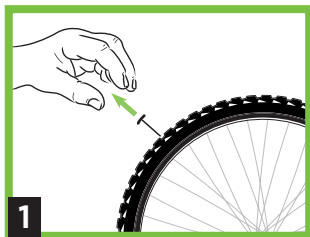

Deflate tire. Remove any puncturing objects.

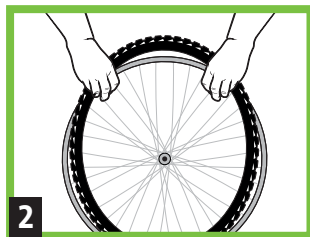

Work one side of the tire off the rim. Remove old tube.

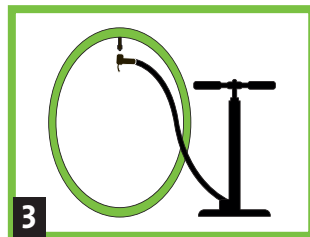

Before installing, slightly inflate new tube to give it shape.

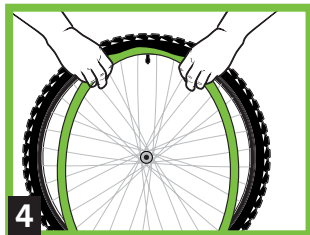

Insert tube valve through rim hole. Gently push the tube into place inside the tire.

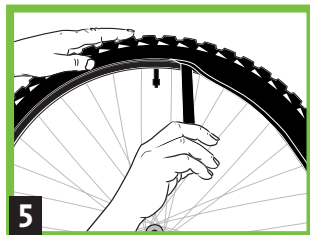

Work tire back onto rim being careful not to pinch the tube. Use of tire levers is recommended.

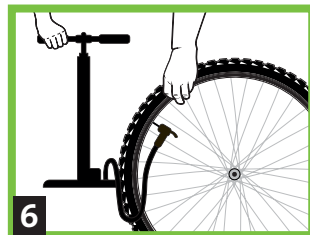

Ensure tire bead is consistently seated around both sides of tire. Inflate to proper PSI.

NOTE: Slime is Not Guaranteed to seal sidewall punctures, pinch flats, glass cuts or punctures over 1/8" (3mm). Be sure to remove any foreign puncturing objects from tire. If necessary, reinflate tire and rotate wheel to create seal. Prior to inflating or deflating a Slime Self-Sealing Tube, rotate tire so valve is at the 10 or 2 o'clock position. This helps sealant to flow away from the valve preventing it from clogging the valve or air source. Do not overinflate tire.

WARNING: Eye protection must be worn during installation.