

E-Z LOCK® DOUBLE SNAP INSTALLATION INSTRUCTIONS

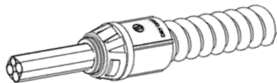

Insert the cable and snap the connector over the cable armor.
Sight window confirms proper cable engagement.

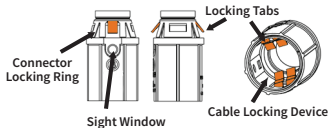
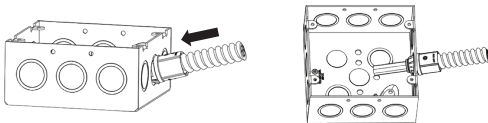

Position one of the locking tabs through the knockout and against inner box wall.

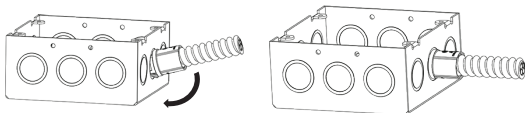

To attach, snap the second tab into the knockout for a flush connection.

E-Z LOCK[®] REMOVAL INSTRUCTIONS

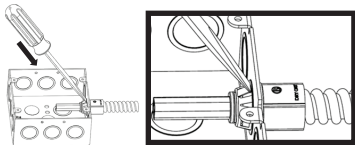

To remove from box, use a flat blade screwdriver to press one of the two locking tabs.

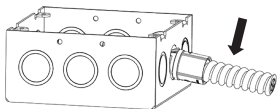

With the tab disengaged, tilt down and remove the connector from the knockout.

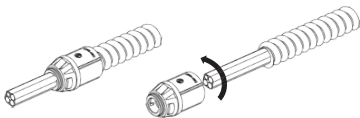

To remove from cable, unscrew counterclockwise. To reuse, raise the pressed flat tab up to its original position, using a flat head screwdriver.



Scan code for
installation video

